

TUNGSTEN CARBIDE TOOLS

utensileria in metallo duro

hard metal tools

CATALOGO FRESATURA

INSERTI E UTENSILI A FISSAGGIO MECCANICO

MILLING CATALOG

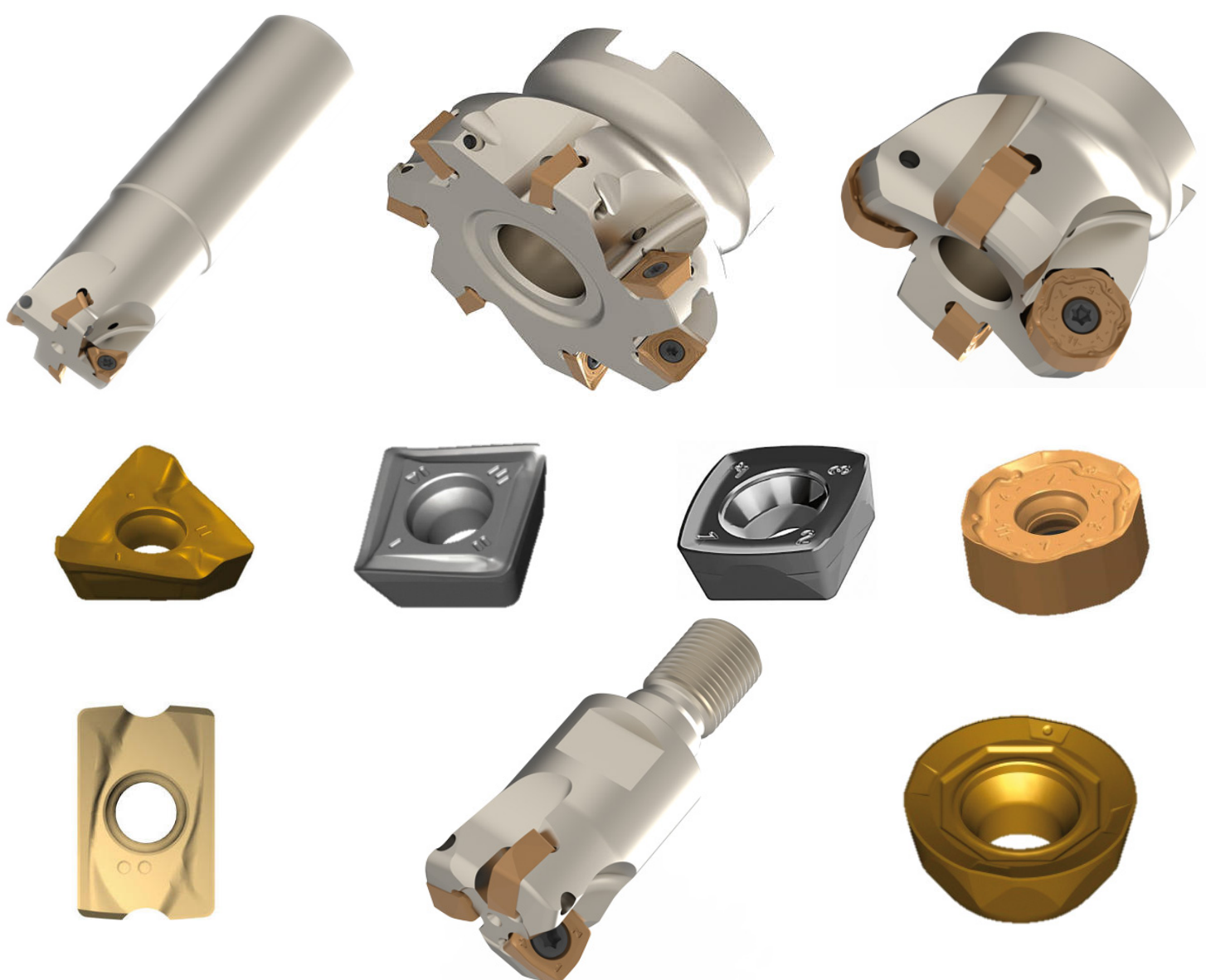

Note:

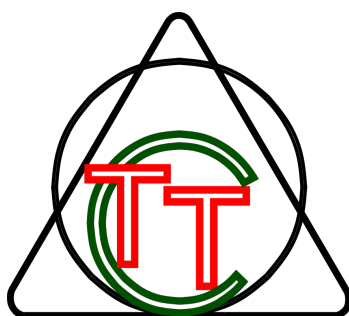

TUNGSTEN CARBIDE TOOLS

Via G. Boccaccio, 19
20025 Legnano (MI)
ITALIA

+39 (0)331/592303
info@tct-srl.it

ver. 01/2022



INDICE

FRESE SPALLAMENTO RETTO 90° pag. 4

FRESE PER SPIANATURA 45° pag. 12

FRESE PER COPIATURA pag. 22

FRESA AD ELEVATI AVANZAMENTI pag. 32

RICAMBI pag. 37

INSERTI STANDARD pag. 38

SPALLAMENTO RETTO 90°

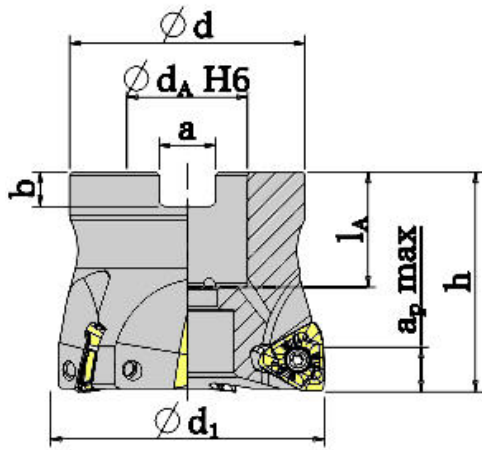

FM90

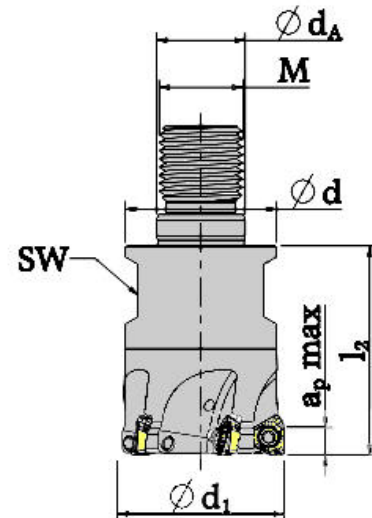

FT90

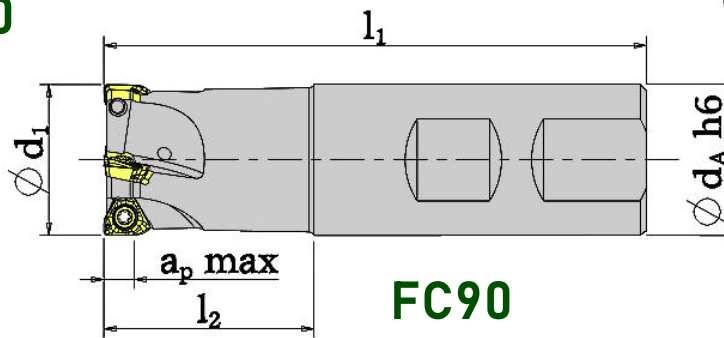

FC90

| Denominazione | d1 | l1 | l2 | h | dA | ap max | nmax | z |
|-----------------------|----|-----|----|----|------|--------|-------|---|
| FM90-T07-40.R.05 | 40 | | | 40 | 17 | 5 | 17000 | 5 |
| FM90-T09-40.R.04 | 40 | | | 40 | 16 | 8 | 17000 | 4 |
| FM90-T09-50.R.05 | 50 | | | 40 | 22 | 8 | 14800 | 5 |
| FM90-T09-63.R.06 | 63 | | | 40 | 22 | 8 | 12850 | 6 |
| FC90-T07-20.R.03-B | 20 | 77 | 25 | | 20 | 5 | 22000 | 3 |
| FC90-T07-25.R.04-B | 25 | 90 | 34 | | 25 | 5 | 20000 | 4 |
| FC90-T07-32.R.05-B | 32 | 102 | 40 | | 32 | 5 | 19700 | 5 |
| FC90-T09-32.R.03-B-40 | 32 | 102 | 40 | | 32 | 8 | 19700 | 3 |
| FT90-T07-20.R.03 | 20 | | | | 10,5 | 5 | 36900 | 3 |
| FT90-T07-25.R.04 | 25 | | | | 12,5 | 5 | 33200 | 4 |
| FT90-T07-32.R.05 | 32 | | | | 17 | 5 | 30200 | 5 |

| Denominazione | Quantità | Per inserto | Ricambi |
|---------------|----------|-------------|--------------------|
| VBTL25/C6 | 10 | TX07 | Vite |
| VBTL30/C7 | 10 | TX09 | Vite |
| VBTL-D80/C | 10 | TX09 | vite differenziale |

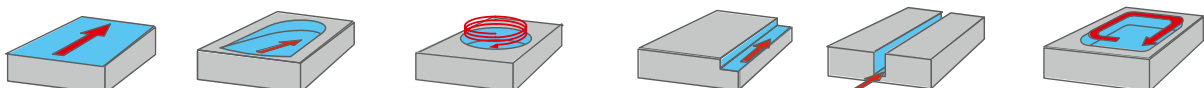

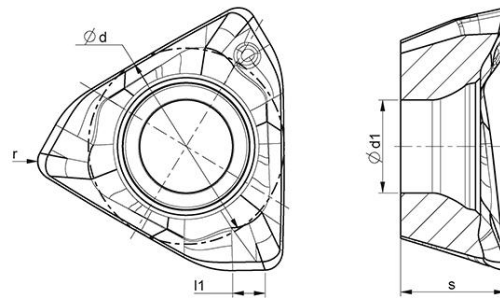

| Denominazione | s | d | l1 | r | d1 |
|-----------------------|------|------|-----|-----|-----|
| TX 070305PDER-TM TC25 | 3,15 | 5,9 | 1 | 0,5 | 2,8 |
| TX 070305PDER-TM TC35 | 3,15 | 5,9 | 1 | 0,5 | 2,8 |
| TX 070305PDER-TS TC50 | 3,15 | 5,9 | 1 | 0,5 | 2,8 |
| TX 070305PDER-TS TM35 | 3,15 | 5,9 | 1 | 0,5 | 2,8 |
| TX 070308PDER-TM TC25 | 3,15 | 5,9 | 1 | 0,8 | 2,8 |
| TX 070308PDER-TM TC35 | 3,15 | 5,9 | 1 | 0,8 | 2,8 |
| TX 070308PDER-TS TC50 | 3,15 | 5,9 | 1 | 0,8 | 2,8 |
| TX 070308PDER-TS TM35 | 3,15 | 5,9 | 1 | 0,8 | 2,8 |
| TX 09T308PDER-TM TC25 | 3,8 | 9,53 | 1,5 | 0,8 | 3,4 |
| TX 09T308PDER-TM TC35 | 3,8 | 9,53 | 1,5 | 0,8 | 3,4 |
| TX 09T308PDER-TS TC50 | 3,8 | 9,53 | 1,5 | 0,8 | 3,4 |
| TX 09T308PDER-TS TM35 | 3,8 | 9,53 | 1,5 | 0,8 | 3,4 |
| TX 09T312PDER-TM TC25 | 3,8 | 9,53 | 1,5 | 1,2 | 3,4 |
| TX 09T312PDER-TM TC35 | 3,8 | 9,53 | 1,5 | 1,2 | 3,4 |
| TX 09T312PDER-TS TC50 | 3,8 | 9,53 | 1,5 | 1,2 | 3,4 |
| TX 09T312PDER-TS TM35 | 3,8 | 9,53 | 1,5 | 1,2 | 3,4 |
| TX 09T316PDER-TM TC25 | 3,8 | 9,53 | 1,5 | 1,6 | 3,4 |
| TX 09T316PDER-TM TC35 | 3,8 | 9,53 | 1,5 | 1,6 | 3,4 |
| TX 09T316PDER-TS TC50 | 3,8 | 9,53 | 1,5 | 1,6 | 3,4 |
| TX 09T316PDER-TS TM35 | 3,8 | 9,53 | 1,5 | 1,6 | 3,4 |

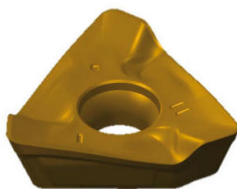
TM

Tagliante forte per applicazioni generali
in acciaio e condizioni difficili

Strong cutting edge for general
steel applications and hard

TS

Tagliante affilato per acciaio inossidabile
applicazioni e per finitura degli acciai.

Sharp cutting edge for general stainless steel
applications and for finishing in steels.

TAGLIANTI REALI DIPONIBILI EFFECTIVE CUTTING EDGE



PARAMETRI DI TAGLIO - CUTTING DATA

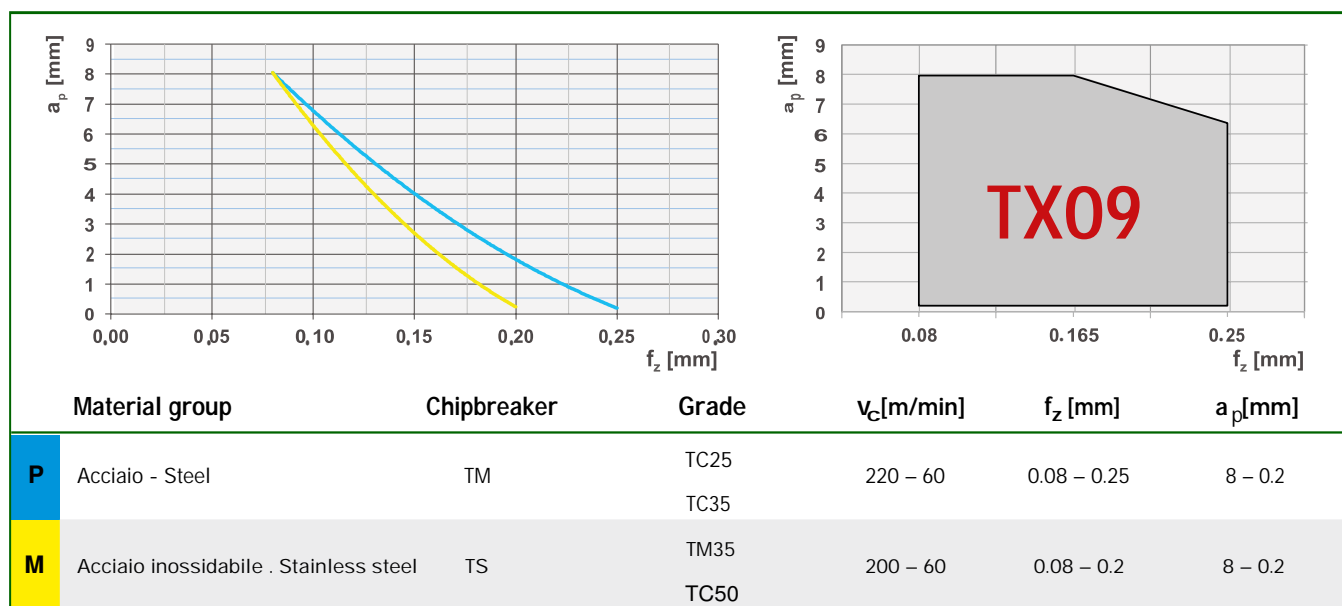
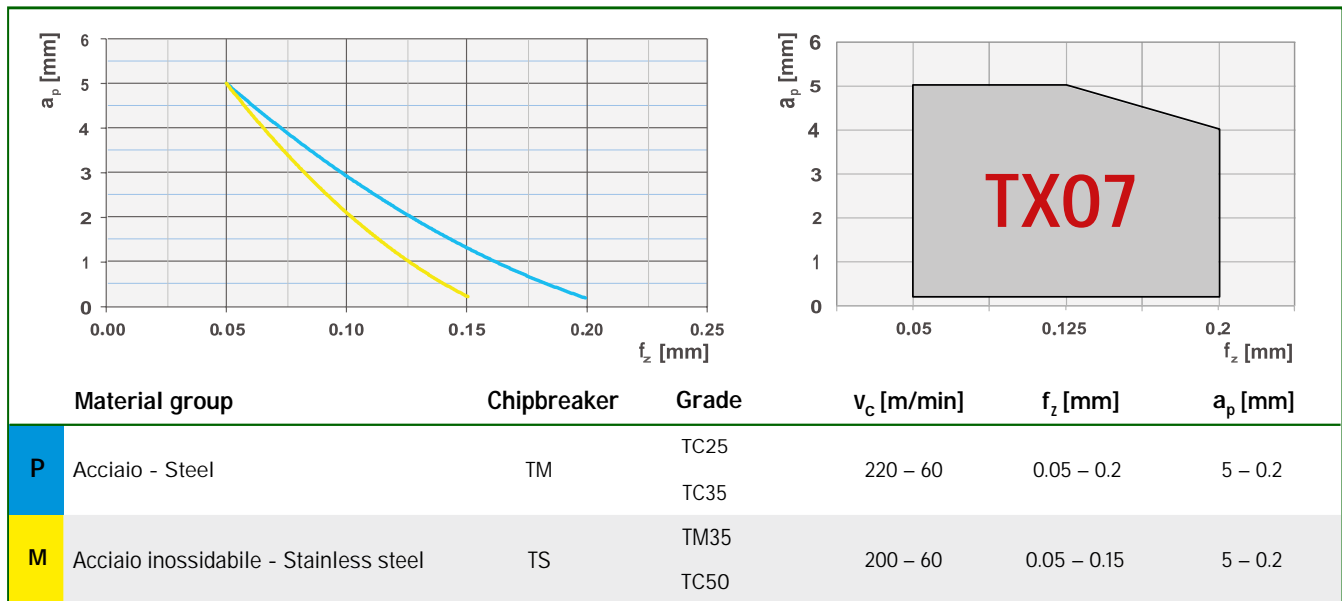



| Denominazione | d1 | l1 | l2 | h | dA | ap max | nmax | z |
|------------------|----|----|----|----|----|--------|-------|---|
| FM90-LN12-50.R05 | 50 | | | 40 | 22 | 12 | 14800 | 5 |

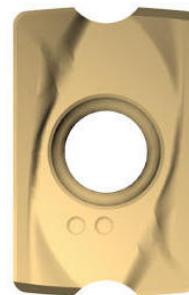
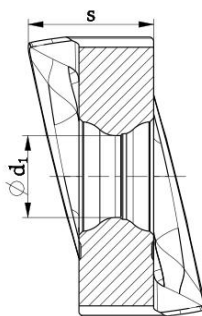
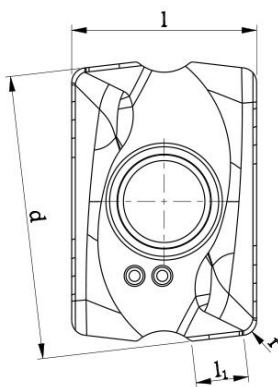

TS

TM

| Denominazione | l | s | d | l1 | r | d1 | x |
|-------------------|----|------|-------|-----|-----|-----|----|
| LX 120608-TM TC25 | 10 | 6,78 | 15,27 | 2,8 | 0,8 | 4,4 | 0° |
| LX 120608-TM TC35 | 10 | 6,78 | 15,27 | 2,8 | 0,8 | 4,4 | 0° |
| LX 120608-TS TM25 | 10 | 6,78 | 15,27 | 2,8 | 0,8 | 4,4 | 0° |

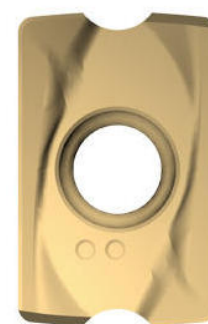
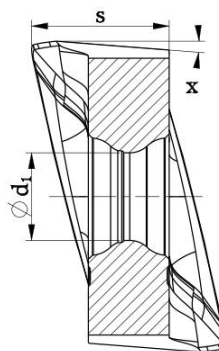
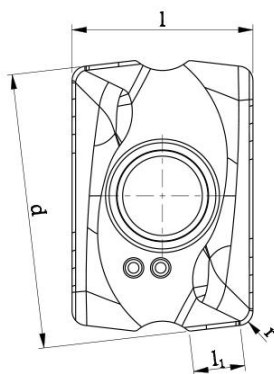

| Denominazione | l | s | d | l1 | r | d1 |
|-------------------|----|------|-------|-----|-----|-----|
| LU 120608-TS TM25 | 10 | 6,87 | 15,86 | 2,6 | 0,8 | 4,4 |

FRESA SPALLAMENTO RETTO 90°

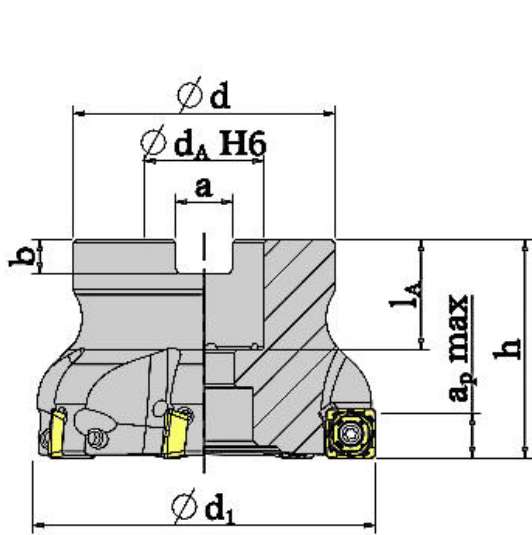

FM90

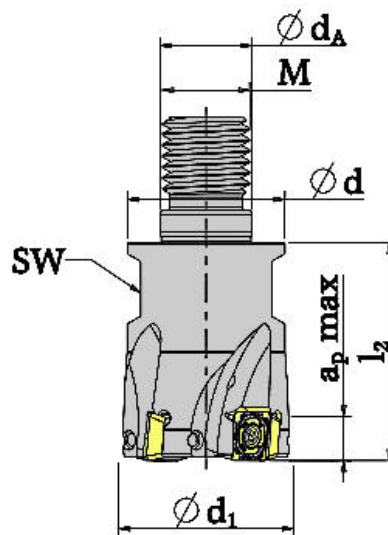

FT90

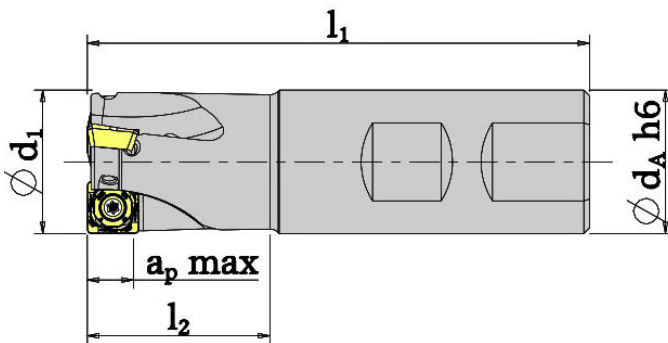

FC90

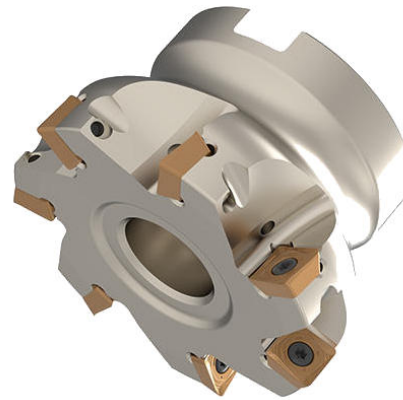

| Denominazione | d1 | l1 | l2 | h | dA | ap max | nmax | z |
|-----------------------|----|-----|----|----|----|--------|-------|---|
| FM90-S09-40.R.05 | 40 | | | 40 | 16 | 8 | 17000 | 5 |
| FM90-S09-50.R.06 | 50 | | | 40 | 22 | 8 | 14800 | 6 |
| FM90-S09-63.R.07 | 63 | | | 40 | 22 | 8 | 12855 | 7 |
| FM90-S09-80.R.09 | 80 | | | 50 | 27 | 8 | 11250 | 9 |
| FM90-S12-40.R.04 | 40 | | | 40 | 16 | 10 | 17000 | 4 |
| FM90-S12-50.R.05 | 50 | | | 40 | 22 | 10 | 14800 | 5 |
| FM90-S12-63.R.06 | 63 | | | 40 | 22 | 10 | 12850 | 6 |
| FM90-S12-80.R.07 | 80 | | | 50 | 27 | 10 | 11250 | 7 |
| FC90-S09-25.R.03-B | 32 | 88 | 32 | | 25 | 8 | 23700 | 3 |
| FC90-S09-32.R.04-B | 40 | 100 | 40 | | 40 | 8 | 19700 | 4 |
| FC90-S12-32.R.03-B-40 | 32 | 100 | 40 | | 32 | 10 | 19700 | 3 |

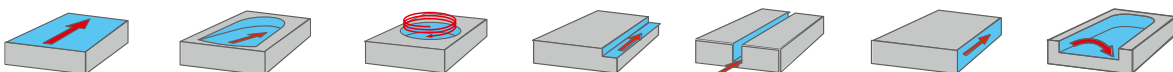

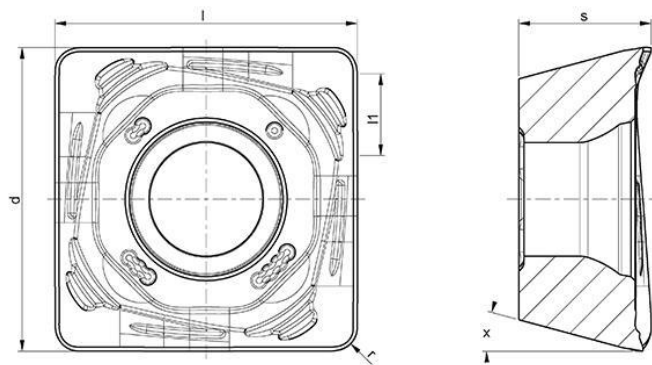

| Denominazione | l | s | d | l1 | r | d1 | x |
|---------------------|------|------|------|-----|-----|-----|---------|
| SH 09T308FR-AL A10M | 9 | 3,97 | 9 | 2,5 | 0,8 | 3,4 | 15,00 ° |
| SH 120508FR-AL A10M | 12,3 | 5 | 12,3 | 2,5 | 0,8 | 4,7 | 15,00 ° |
| SX 09T308SR-TC TK20 | 9 | 3,97 | 9 | 2,5 | 0,8 | 3,4 | 15,00 ° |
| SX 09T308SR-TM TC25 | 9 | 3,97 | 9 | 2,5 | 0,8 | 3,4 | 15,00 ° |
| SX 09T308SR-TM TC35 | 9 | 3,97 | 9 | 2,5 | 0,8 | 3,4 | 15,00 ° |
| SX 09T308SR-TS TC50 | 9 | 3,97 | 9 | 2,5 | 0,8 | 3,4 | 15,00 ° |
| SX 09T308SR-TS TC14 | 9 | 3,97 | 9 | 2,5 | 0,8 | 3,4 | 15,00 ° |
| SX 09T308SR-TS TM35 | 9 | 3,97 | 9 | 2,5 | 0,8 | 3,4 | 15,00 ° |
| SX 120508SR-TC TK20 | 12,3 | 5 | 12,3 | 2,5 | 0,8 | 4,7 | 15,00 ° |
| SX 120508SR-TM TC25 | 12,3 | 5 | 12,3 | 2,5 | 0,8 | 4,7 | 15,00 ° |
| SX 120508SR-TM TC35 | 12,3 | 5 | 12,3 | 2,5 | 0,8 | 4,7 | 15,00 ° |
| SX 120508SR-TS TC50 | 12,3 | 5 | 12,3 | 2,5 | 0,8 | 4,7 | 15,00 ° |
| SX 120508SR-TS TC14 | 12,3 | 5 | 12,3 | 2,5 | 0,8 | 4,7 | 15,00 ° |
| SX 120508SR-TS TM35 | 12,3 | 5 | 12,3 | 2,5 | 0,8 | 4,7 | 15,00 ° |



AL



TC

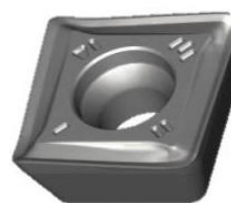

TS

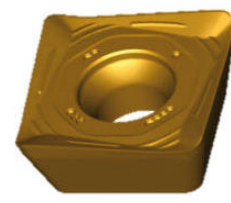

TM

| Denominazione | Quantità | Per inserto | Ricambi |
|---------------|----------|-------------|-------------------------------------|
| VBTL40/C8 | 10 | SX12 | Vite solo per FC90-S12-32.R.03-B-40 |
| VBTL40/C11 | 10 | SX12 | Vite |
| VBTL30/C7 | 10 | SX09 | Vite |
| VBTL-D80/C | 10 | SX09 | vite differenziale |



TAGLIENTI REALI DIPONIBILI

EFFECTIVE CUTTING EDGE



TM

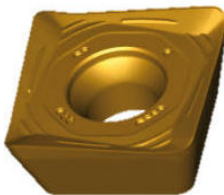

Tagliente robusto per applicazioni generiche di fresatura acciaio in condizioni difficili

Strong cutting edge for general steel applications and hard conditions milling

TS



Tagliente affilato per applicazioni generiche in acciaio inossidabile e per la finitura degli acciai.

Sharp cutting edge for general stainless steel applications and for finishing in steels.

TC



Tagliente robusto per applicazioni su ghisa.

Strong cutting edge for cast iron applications.

AL



Tagliente estremamente affilato per alluminio e metalli non ferrosi.

Extremely sharp cutting edge for aluminum and non-ferrous metals.

PARAMETRI DI TAGLIO - CUTTING DATA

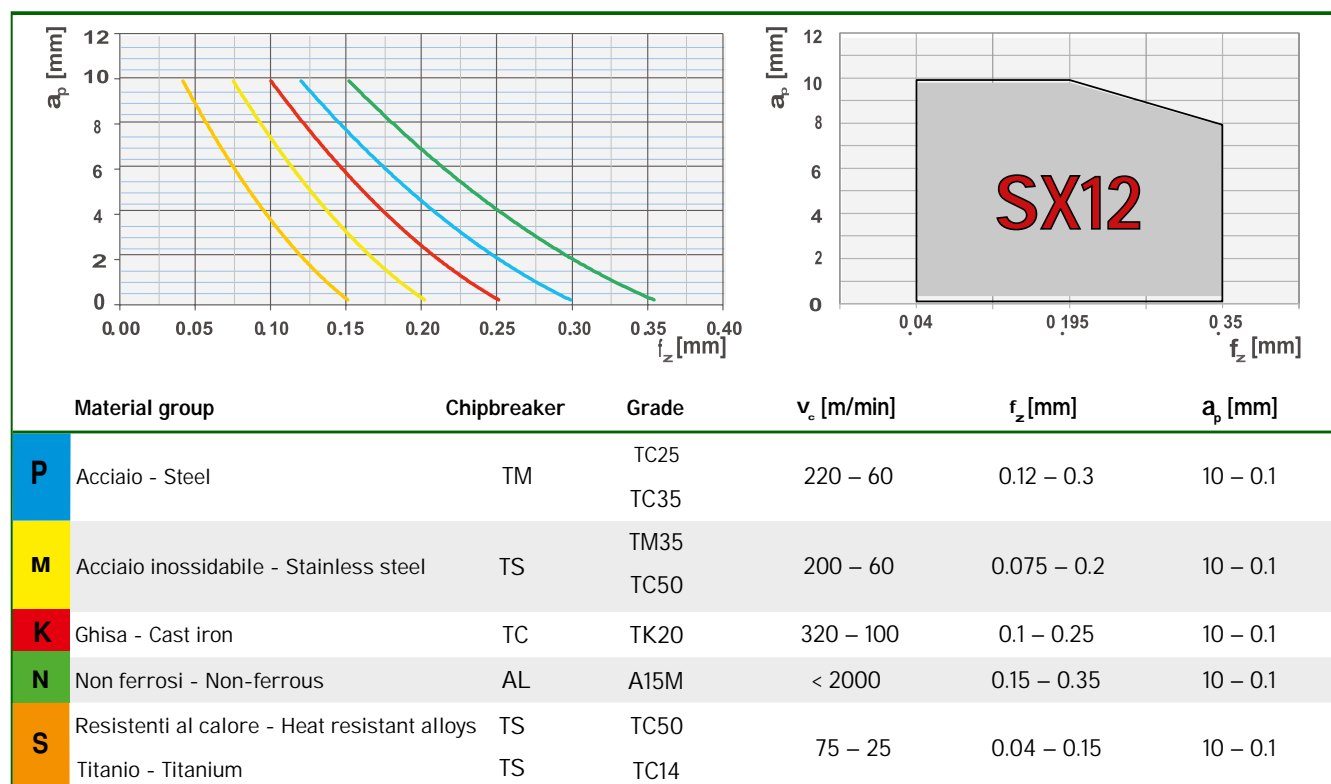
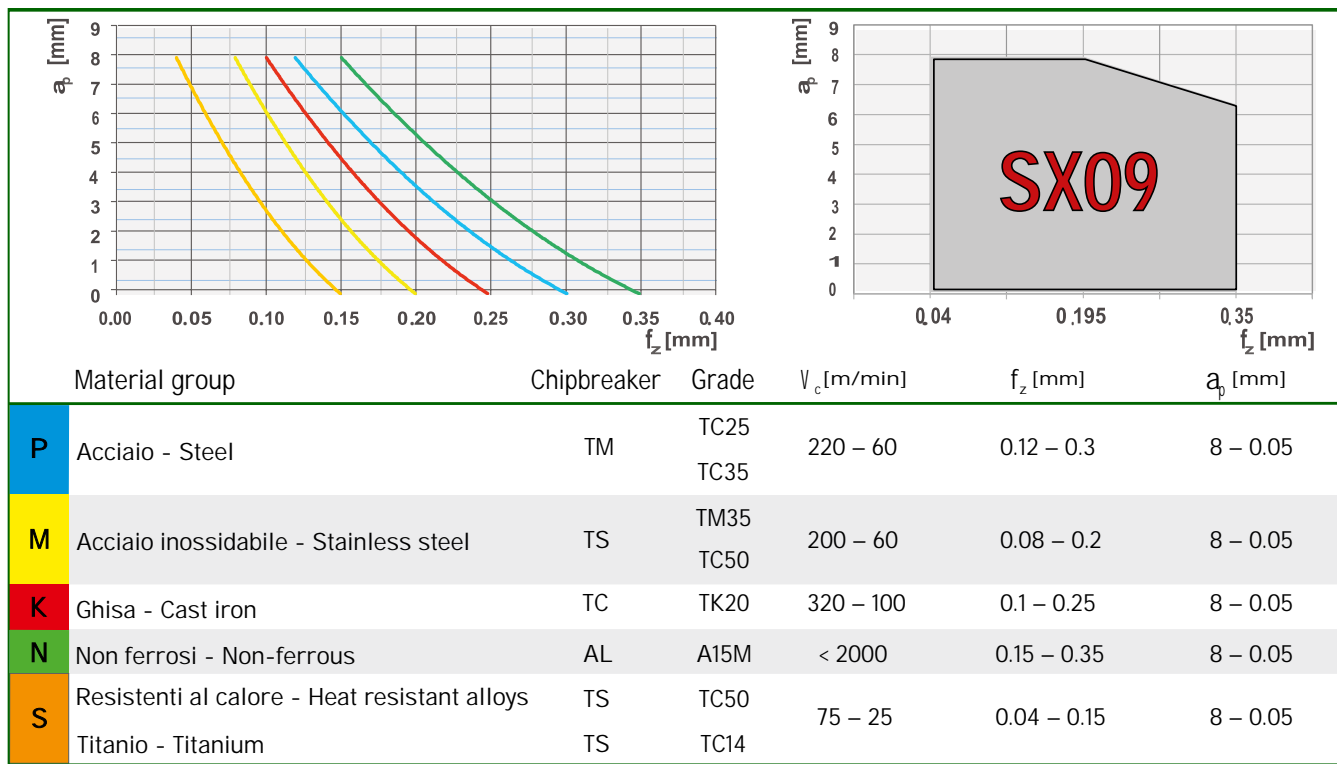

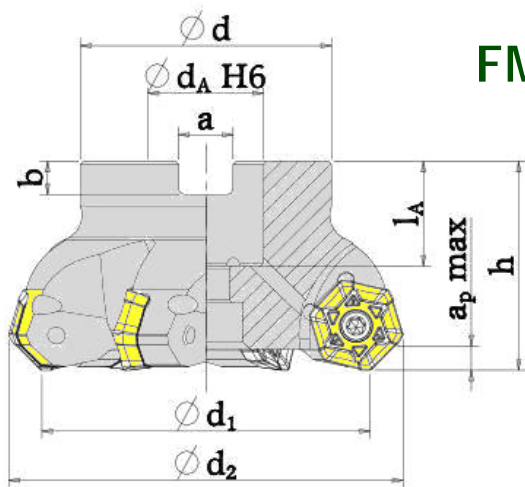

FM45

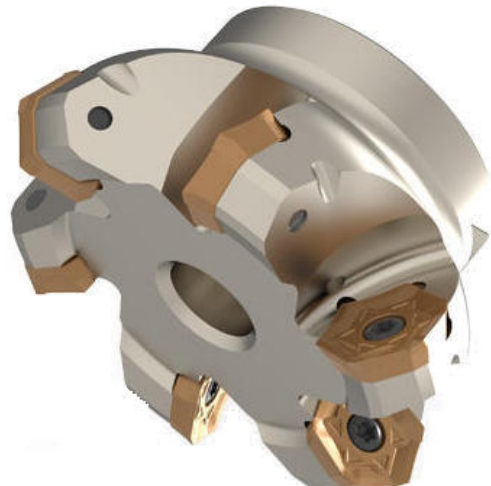

| Denominazione | d1 | l1 | l2 | h | dA | ap max | nmax | z |
|--------------------|-----|-----|----|----|----|--------|-------|----|
| FM45-H06-100.R.09 | 100 | | | 50 | 32 | 4,5 | 7900 | 9 |
| FM45-H06-125.R.10 | 125 | | | 63 | 40 | 4,5 | 6300 | 10 |
| FM45-H06-40.R.04 | 40 | | | 40 | 16 | 4,5 | 19900 | 4 |
| FM45-H06-50.R.05 | 50 | | | 40 | 22 | 4,5 | 15900 | 5 |
| FM45-H06-63.R.06 | 63 | | | 40 | 22 | 4,5 | 12600 | 6 |
| FM45-H06-80.R.07 | 80 | | | 50 | 27 | 4,5 | 9900 | 7 |
| FC45-H06-40.R.04-B | 40 | 110 | 50 | | 32 | 4,5 | 17000 | 4 |

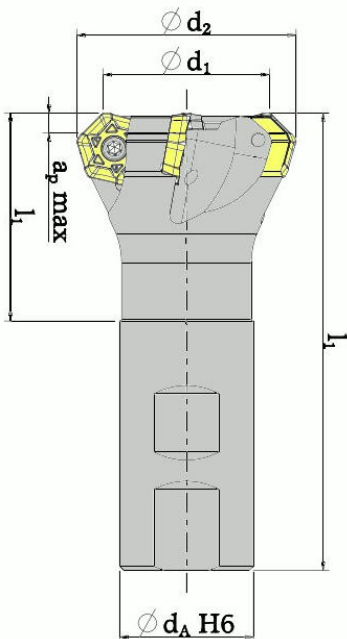

FC45

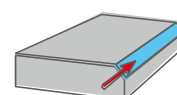
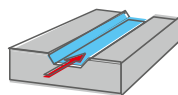
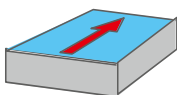

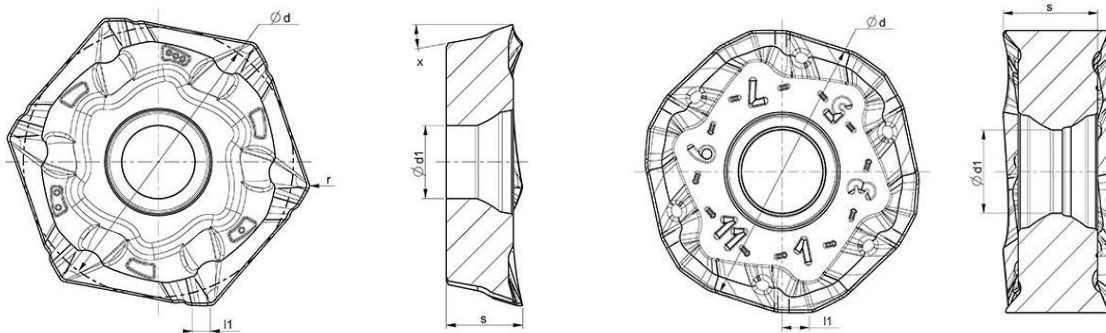

| Denominazione | s | d | l1 | r | d1 |
|-----------------------|-----|------|-----|-----|-----|
| HO 0604AZER - TS TC50 | 4,5 | 16,3 | 1,7 | 0,4 | 4,4 |
| HO 0604AZER - TS TM35 | 4,5 | 16,3 | 1,7 | 0,4 | 4,4 |
| HT 0604AZER - TM TC25 | 4,5 | 16,3 | 1,7 | 0,4 | 4,4 |
| HT 0604AZER - TM TC35 | 4,5 | 16,3 | 1,7 | 0,4 | 4,4 |
| HU 0806AZER - TM TC25 | 5,3 | 14,7 | 1,5 | | 4,1 |
| HU 0806AZER - TM TC35 | 5,3 | 14,7 | 1,5 | | 4,1 |
| HU 0806AZER - TS TC50 | 5,3 | 14,7 | 1,5 | | 4,1 |
| HU 0806AZER - TS TM25 | 5,3 | 14,7 | 1,5 | | 4,1 |

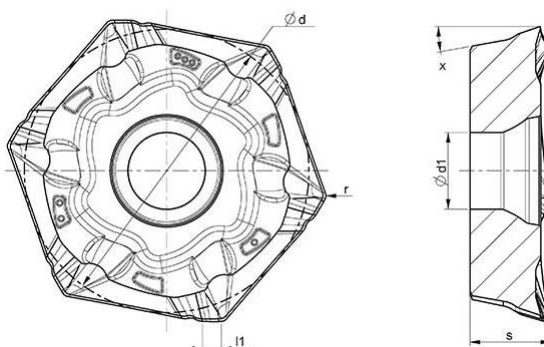

| Denominazione | s | d | ap | l1 | r | d1 | x |
|-------------------------|-----|------|----|-----|-----|-----|---------|
| HPCT 0604AZFR -AL A10M | 4,5 | 16,3 | | 1,7 | 0,4 | 4,4 | 11,00 ° |
| HPKT 0604AZER - TM TC25 | 4,5 | 16,3 | 4 | 1,7 | 0,4 | 4,4 | 11,00 ° |
| HPKT 0604AZER - TM TC35 | 4,5 | 16,3 | | 1,7 | 0,4 | 4,4 | 11,00 ° |
| HPKT 0604AZER - TS TC50 | 4,5 | 16,3 | | 1,7 | 0,4 | 4,4 | 11,00 ° |

| Denominazione | Quantità | Ricambi |
|---------------|----------|--------------------|
| VBTL40/C11 | 10 | Vite |
| VBTL D80/C | 10 | Vite differenziale |



TAGLIENTI REALI DIPONIBILI

EFFECTIVE CUTTING EDGE

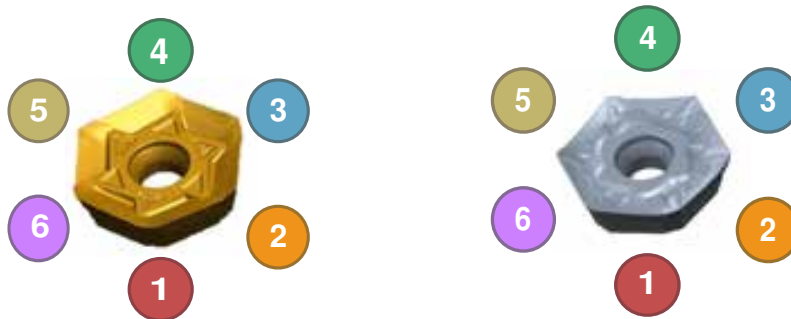

TM



Tagliante robusto per applicazioni generiche di fresatura acciaio in condizioni difficili

Strong cutting edge for general steel applications and hard conditions milling

TS



Tagliante affilato per applicazioni generiche in acciaio inossidabile e per la finitura degli acciai.

Sharp cutting edge for general stainless steel applications and for finishing in steels.

AL

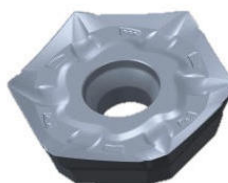

Tagliante estremamente affilato per alluminio e metalli non ferrosi.

Extremely sharp cutting edge for aluminum and non-ferrous metals.

HU 0806



PARAMETRI DI TAGLIO - CUTTING DATA INSERTI HPKT / HO / HT

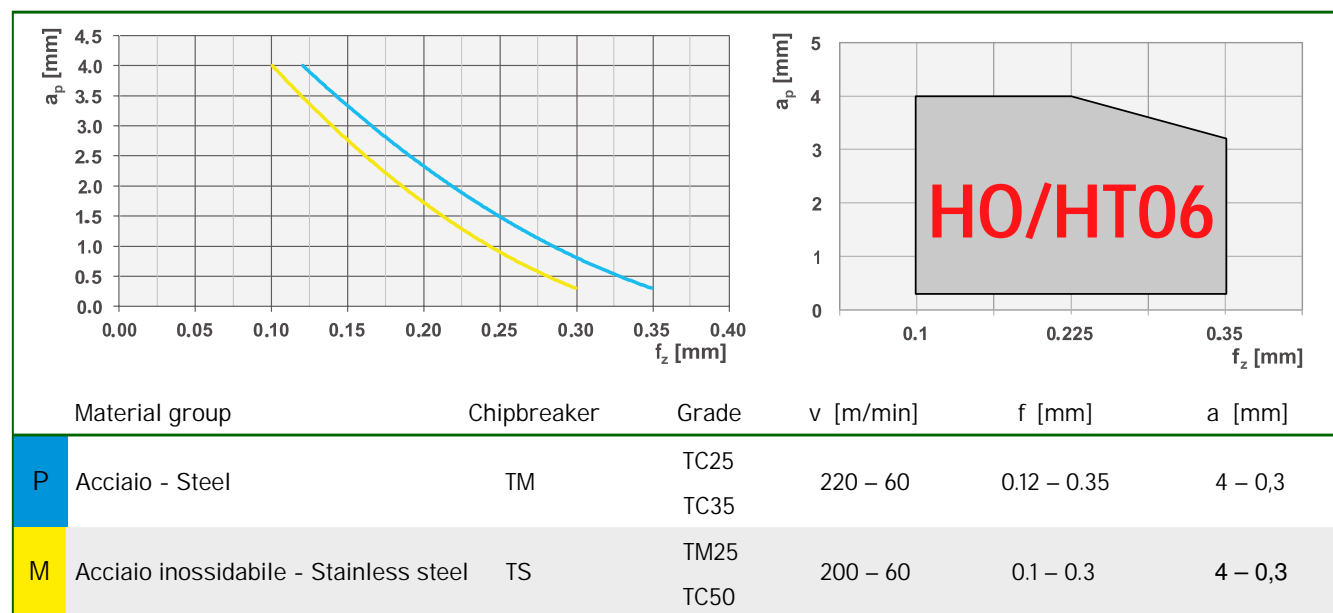
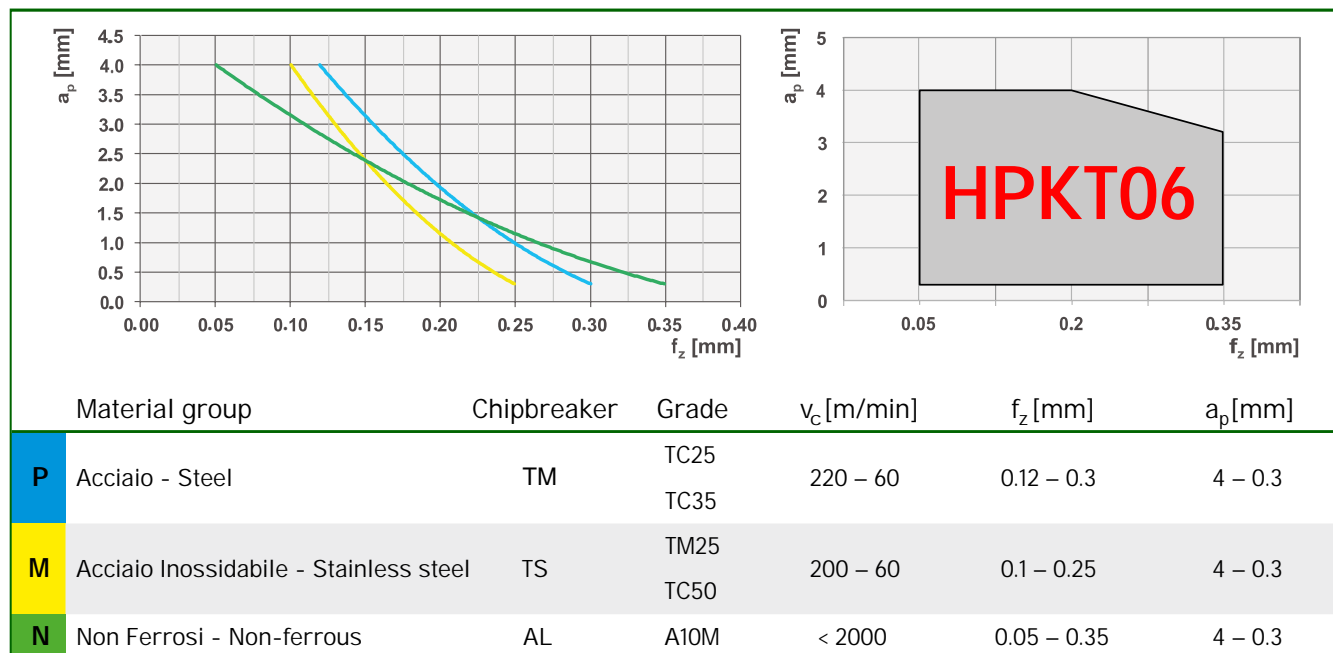

FRESA SPIANATURA 45° X 8

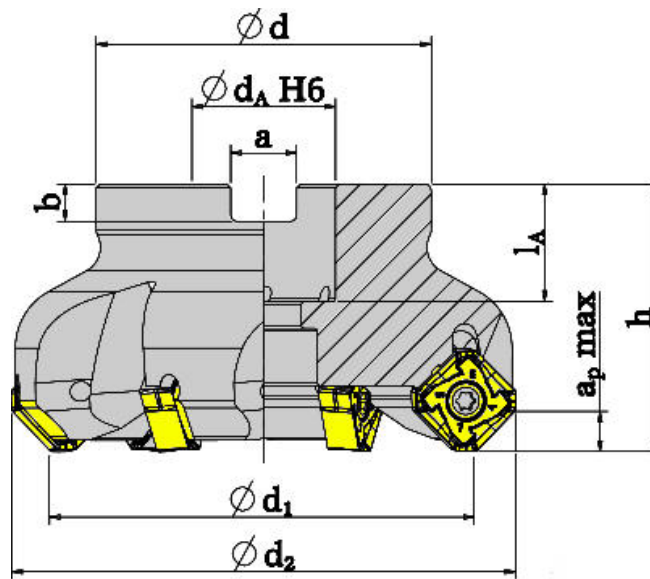

| Denominazione | d1 | h | dA | ap max | nmax | z |
|-------------------|-----|----|----|--------|-------|----|
| FM45-S12-100.R.10 | 100 | 50 | 32 | 6 | 7900 | 10 |
| FM45-S12-125.R.12 | 125 | 63 | 40 | 6 | 6300 | 12 |
| FM45-S12-40.R.04 | 40 | 45 | 16 | 6 | 19900 | 4 |
| FM45-S12-50.R.05 | 50 | 45 | 22 | 6 | 15900 | 5 |
| FM45-S12-63.R.06 | 63 | 45 | 22 | 6 | 12600 | 6 |
| FM45-S12-80.R.08 | 80 | 50 | 27 | 6 | 9900 | 8 |
| FM45-S15-100.R.07 | 100 | 50 | 32 | 6,5 | 6300 | 7 |
| FM45-S15-125.R.08 | 125 | 63 | 40 | 6,5 | 5000 | 8 |
| FM45-S15-160.R.10 | 160 | 63 | 40 | 6,5 | 3800 | 10 |
| FM45-S15-40.R.04 | 40 | 45 | 16 | 6,5 | 15900 | 4 |
| FM45-S15-50.R.04 | 50 | 45 | 22 | 6,5 | 12700 | 4 |
| FM45-S15-63.R.05 | 63 | 45 | 22 | 6,5 | 10100 | 5 |
| FM45-S15-80.R.06 | 80 | 50 | 27 | 6,5 | 7900 | 6 |

| Denominazione | Quantità | Per inserto | Ricambi |
|---------------|----------|-------------|--------------------|
| VBTL40/C11 | 10 | S012 | Vite |
| VBTL45/C13 | 10 | S015 | |
| VBTL -D80/C | 10 | S015 | Vite differenziale |

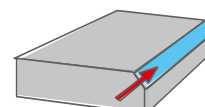
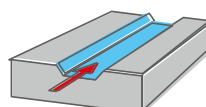
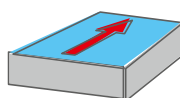

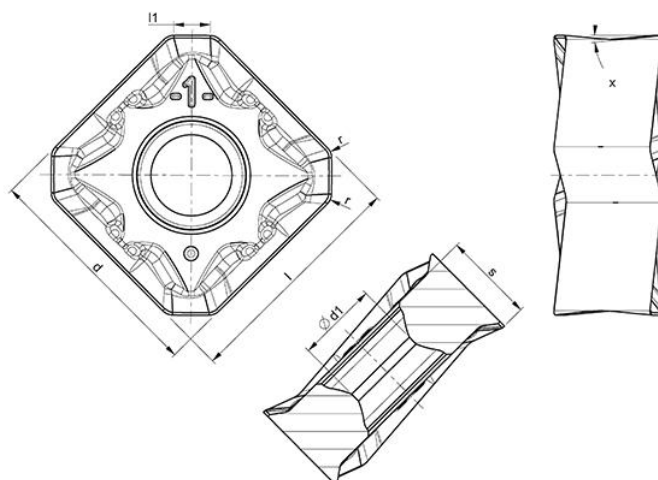

| Denominazione | l | s | d | l1 | r | d1 |
|---------------------|-------|---|-------|-----|-----|------|
| SO 1205AZER-TM TC25 | 13 | 5 | 13 | 2 | 0,8 | 4,55 |
| SO 1205AZER-TM TC20 | 13 | 5 | 13 | 2 | 0,8 | 4,55 |
| SO 1205AZER-TM TC35 | 13 | 5 | 13 | 2 | 0,8 | 4,55 |
| SO 1205AZER-TS TC50 | 13 | 5 | 13 | 2 | 0,8 | 4,55 |
| SO 1205AZER-TS TM35 | 13 | 5 | 13 | 2 | 0,8 | 4,55 |
| SO 1505AZER-TC TK20 | 15,88 | 6 | 15,88 | 2,7 | 1 | 5,74 |
| SO 1505AZER-TC TK25 | 15,88 | 6 | 15,88 | 2,7 | 1 | 5,74 |
| SO 1505AZER-TM TC25 | 15,88 | 6 | 15,88 | 2,7 | 1 | 5,74 |
| SO 1505AZER-TM TC20 | 15,88 | 6 | 15,88 | 2,7 | 1 | 5,74 |
| SO 1505AZER-TM TC35 | 15,88 | 6 | 15,88 | 2,7 | 1 | 5,74 |
| SO 1505AZER-TS TC50 | 15,88 | 6 | 15,88 | 2,7 | 1 | 5,74 |
| SO 1505AZER-TS TM35 | 15,88 | 6 | 15,88 | 2,7 | 1 | 5,74 |

2 Dimensioni disponibili - Available in 2 dimensions

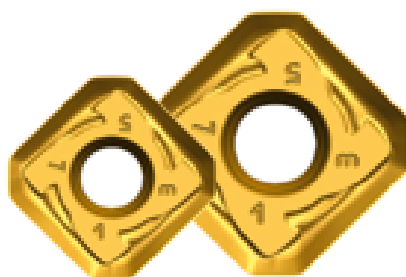

CI 12

CI 15



EFFECTIVE CUTTING EDGE

4 taglienti reversibili 8 totali
 Indexing 4 times and reversible

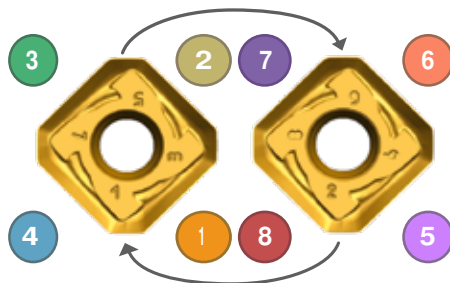

Angolo positivo - Positive Rake angle



TM

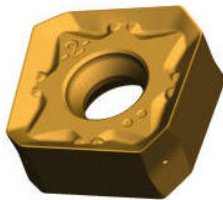

Tagliente robusto per applicazioni generiche di fresatura acciaio in condizioni difficili

Strong cutting edge for general steel applications and hard conditions milling

TS

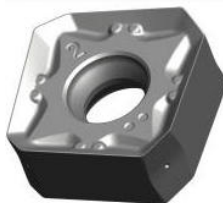

Tagliente affilato per applicazioni generiche su acciaio inossidabile e per la finitura degli acciai.

Sharp cutting edge for general stainless steel applications and for finishing in steels.

TC



Tagliente robusto per applicazioni su ghisa.

Strong cutting edge for cast iron applications.



PARAMETRI DI TAGLIO - CUTTING DATA INSERTI HPKT / HO / HT

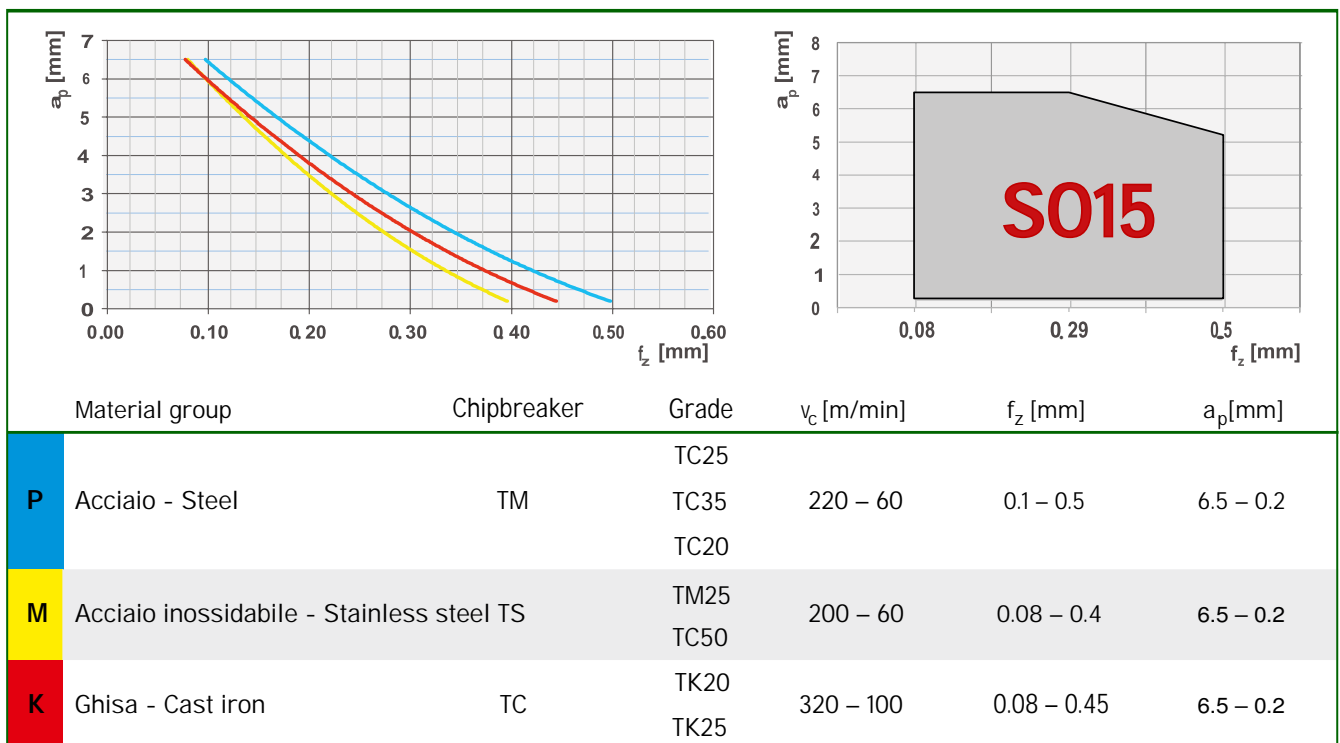
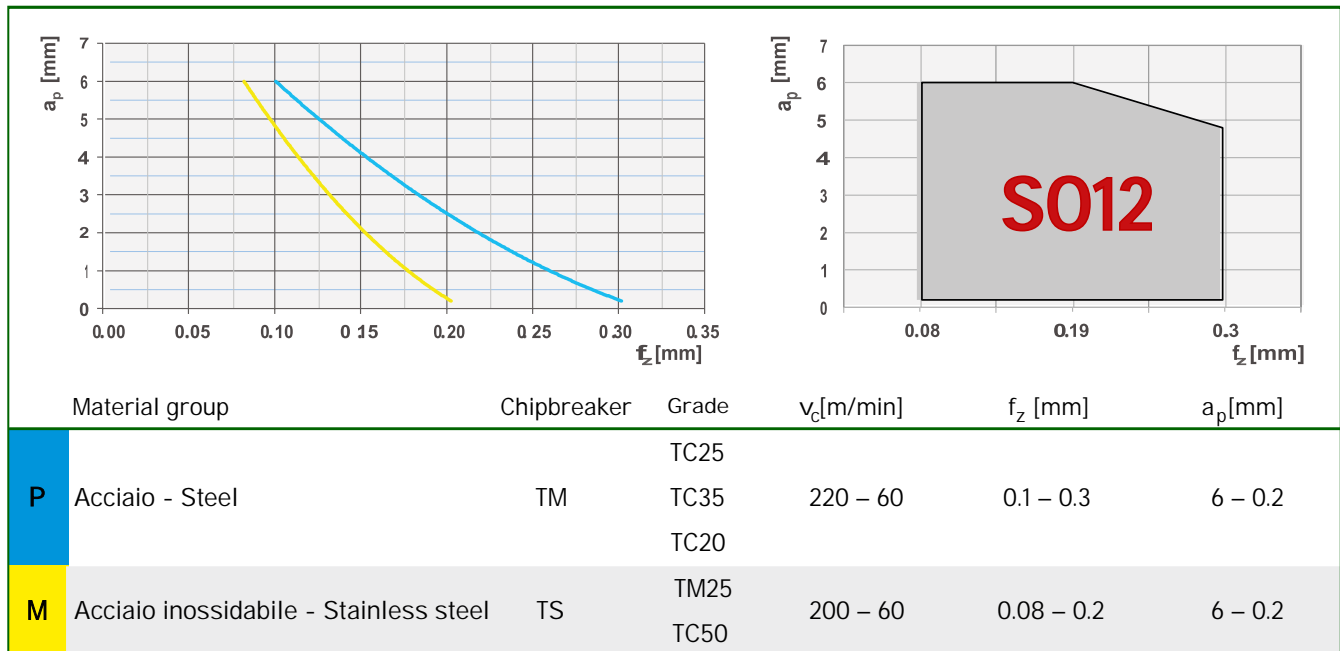

FRESA SPIANATURA 45° X 12

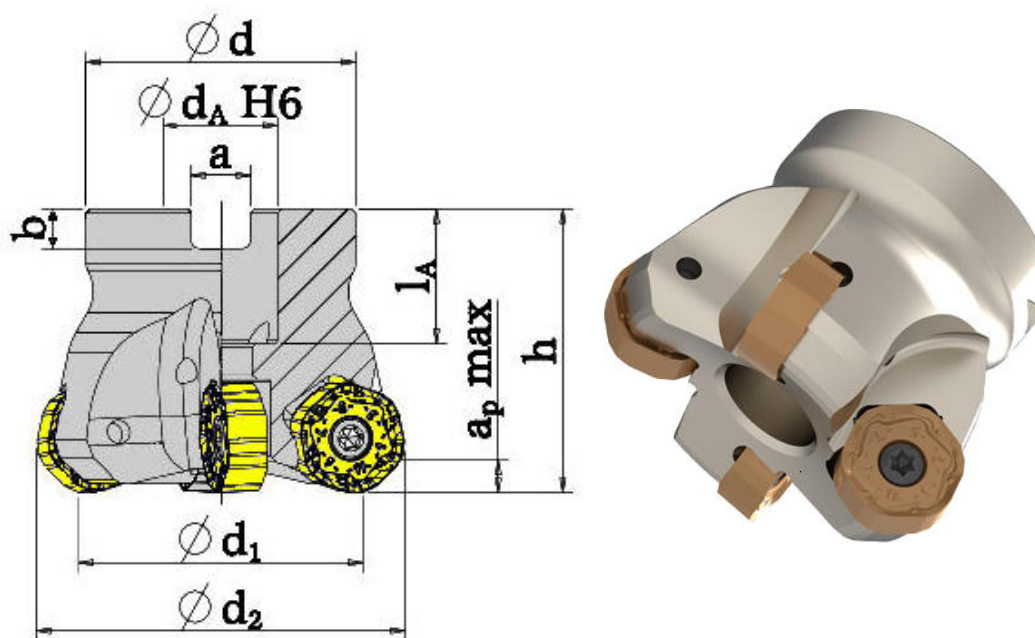

| Denominazione | d1 | h | dA | ap max | nmax | z |
|-------------------|-----|----|----|--------|-------|---|
| FM45-H08-100.R.08 | 100 | 50 | 32 | 4,5 | 6400 | 8 |
| FM45-H08-125.R.09 | 125 | 63 | 40 | 4,5 | 5100 | 9 |
| FM45-H08-40.R.04 | 40 | 40 | 16 | 4,5 | 15900 | 4 |
| FM45-H08-50.R.04 | 50 | 40 | 22 | 4,5 | 12700 | 4 |
| FM45-H08-63.R.05 | 63 | 40 | 22 | 4,5 | 10100 | 5 |
| FM45-H08-80.R.06 | 80 | 50 | 27 | 4,5 | 7900 | 6 |

| Denominazione | Quantità | d | l | l1 | dk | K |
|---------------|----------|----|----|----|-----|-----|
| VBTL40/C11 | 10 | M4 | 11 | 8 | 5,5 | T15 |

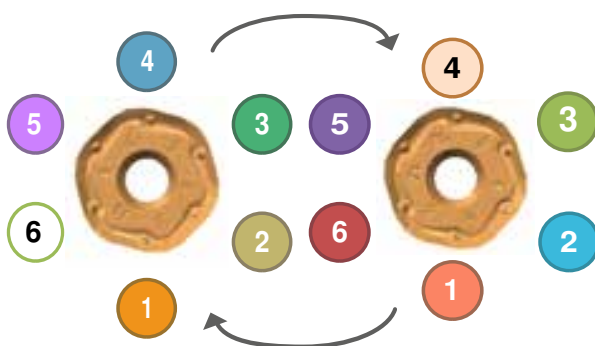
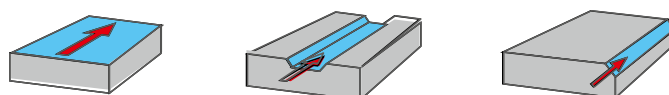

6 taglienti reversibili 12 totali
Indexing 6 times and reversible

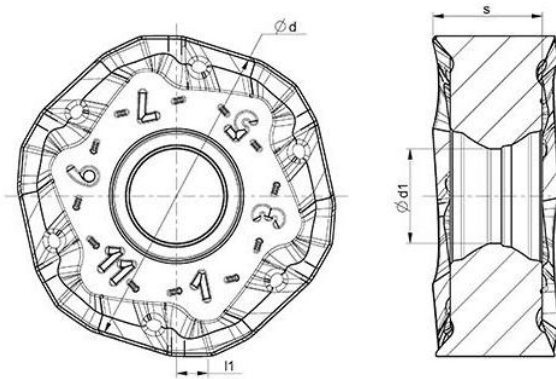

| Denominazione | s | d | l1 | d1 | x |
|---------------------|-----|------|-----|-----|----|
| HN 0806AZER-TM TC25 | 5,3 | 14,7 | 1,5 | 4,1 | 0° |
| HN 0806AZER-TM TC35 | 5,3 | 14,7 | 1,5 | 4,1 | 0° |
| HN 0806AZER-TS TC50 | 5,3 | 14,7 | 1,5 | 4,1 | 0° |

TM

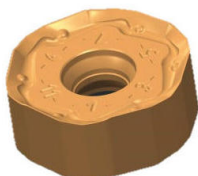

Tagliante robusto per applicazioni generiche di fresatura acciaio in condizioni difficili

Strong cutting edge for general steel applications and hard conditions milling

TS



Tagliante affilato per applicazioni generiche su acciaio inossidabile e per la finitura degli acciai.

Sharp cutting edge for general stainless steel applications and for finishing in steels.

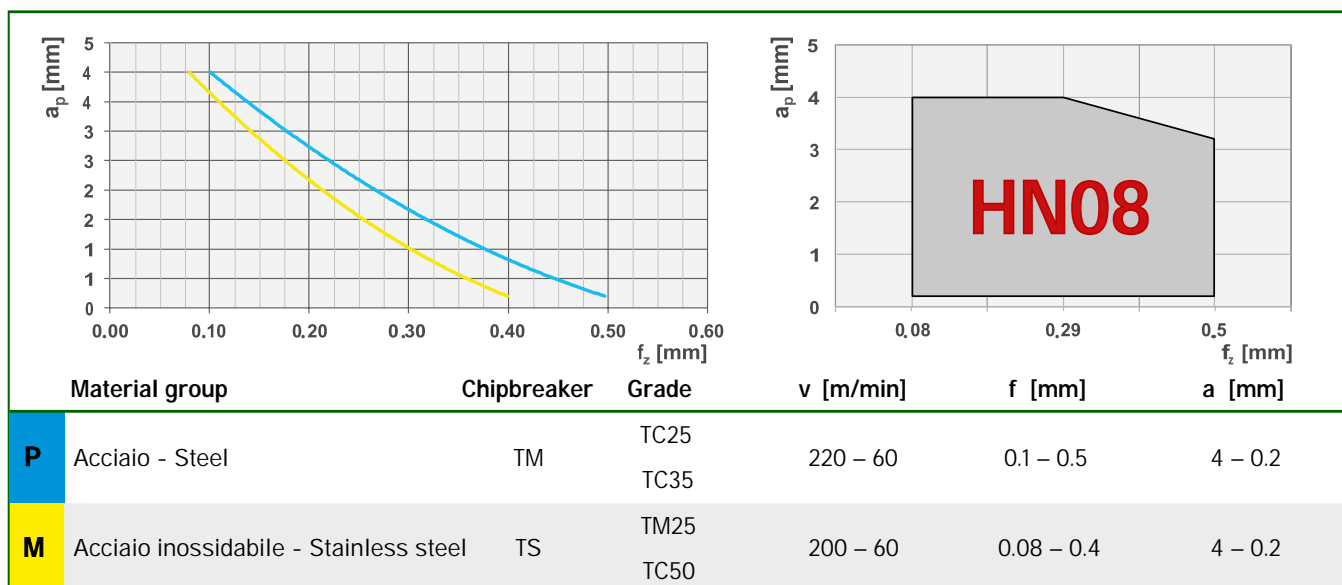

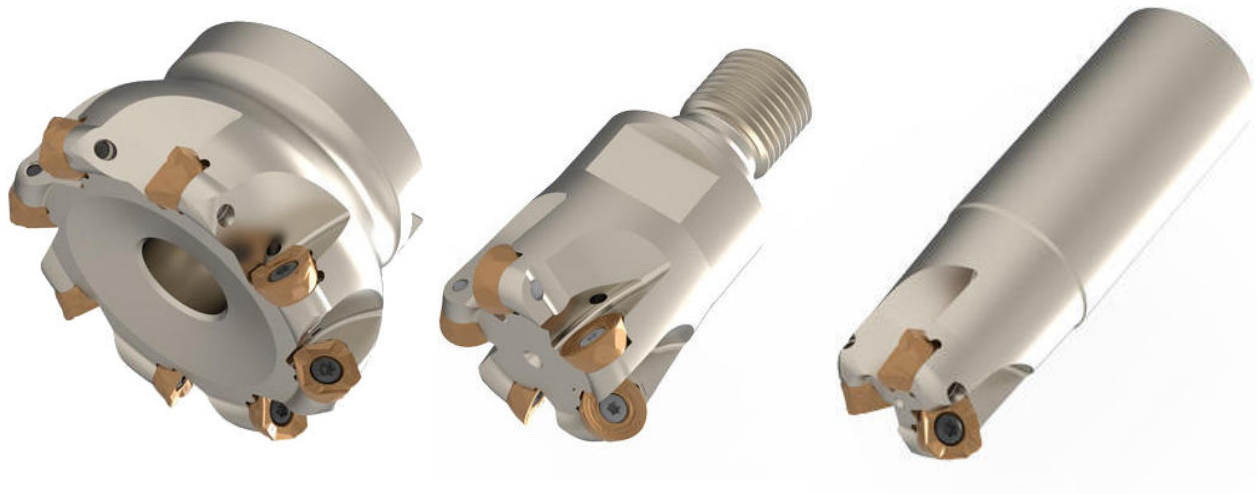

FRESA COPIATURA

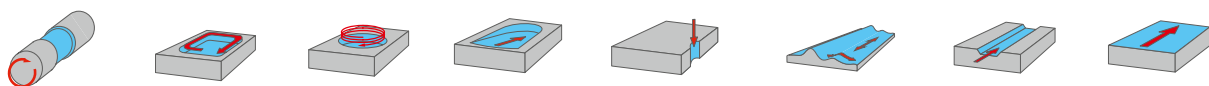

| Denominazione | d1 | l1 | l2 | h | dA | ap max | nmax | z |
|---------------------------|-----|-----|----|----|----|--------|-------|----|
| FM00-R10-40.R.04 | 40 | | | 40 | 16 | 5 | 15900 | 4 |
| FM00-R10-50.R.05 | 50 | | | 40 | 22 | 5 | 12700 | 5 |
| FM00-R12-100.R.10 | 100 | | | 50 | 32 | 6 | 6350 | 10 |
| FM00-R12-40.R.04 | 40 | | | 40 | 16 | 6 | 15900 | 4 |
| FM00-R12-50.R.05 | 50 | | | 40 | 22 | 6 | 12700 | 5 |
| FM00-R12-63.R.06 | 63 | | | 40 | 22 | 6 | 10100 | 6 |
| FM00-R12-80.R.08 | 80 | | | 50 | 27 | 6 | 7950 | 8 |
| FM00-R16-100.R.07 | 100 | | | 50 | 32 | 8 | 6350 | 7 |
| FM00-R16-125.R.08 | 125 | | | 63 | 40 | 8 | 5050 | 8 |
| FM00-R16-50.R.03 | 50 | | | 40 | 22 | 8 | 12700 | 3 |
| FM00-R16-63.R.05 | 63 | | | 40 | 22 | 8 | 10100 | 5 |
| FM00-R16-80.R.06 | 80 | | | 50 | 27 | 8 | 7950 | 6 |
| FC00-R10-20.R.02-A-50 | 20 | 102 | 50 | | 20 | 5 | 31800 | 2 |
| FC00-R10-20.R.02-A-50-165 | 20 | 165 | 50 | | 20 | 5 | 22260 | 2 |
| FC00-R10-25.R.03-A-60 | 25 | 116 | 60 | | 25 | 5 | 20000 | 3 |
| FC00-R10-25.R.03-A-60-165 | 25 | 165 | 60 | | 25 | 5 | 20000 | 3 |
| FC00-R10-32.R.04-A-70 | 32 | 130 | 70 | | 32 | 5 | 19000 | 4 |
| FC00-R10-32.R.04-A-70-165 | 32 | 165 | 70 | | 32 | 5 | 18000 | 4 |
| FC00-R12-25.R.02-A-30 | 25 | 86 | 30 | | 25 | 6 | 25000 | 2 |
| FC00-R12-25.R.02-A-60 | 25 | 116 | 60 | | 25 | 6 | 18000 | 2 |
| FC00-R12-32.R.03-A-40 | 32 | 100 | 40 | | 32 | 6 | 19000 | 3 |
| FC00-R12-32.R.03-A-70 | 32 | 130 | 70 | | 32 | 6 | 17000 | 3 |
| FT00-R10-32.R.04 | 32 | | | | 17 | 5 | 30200 | 4 |

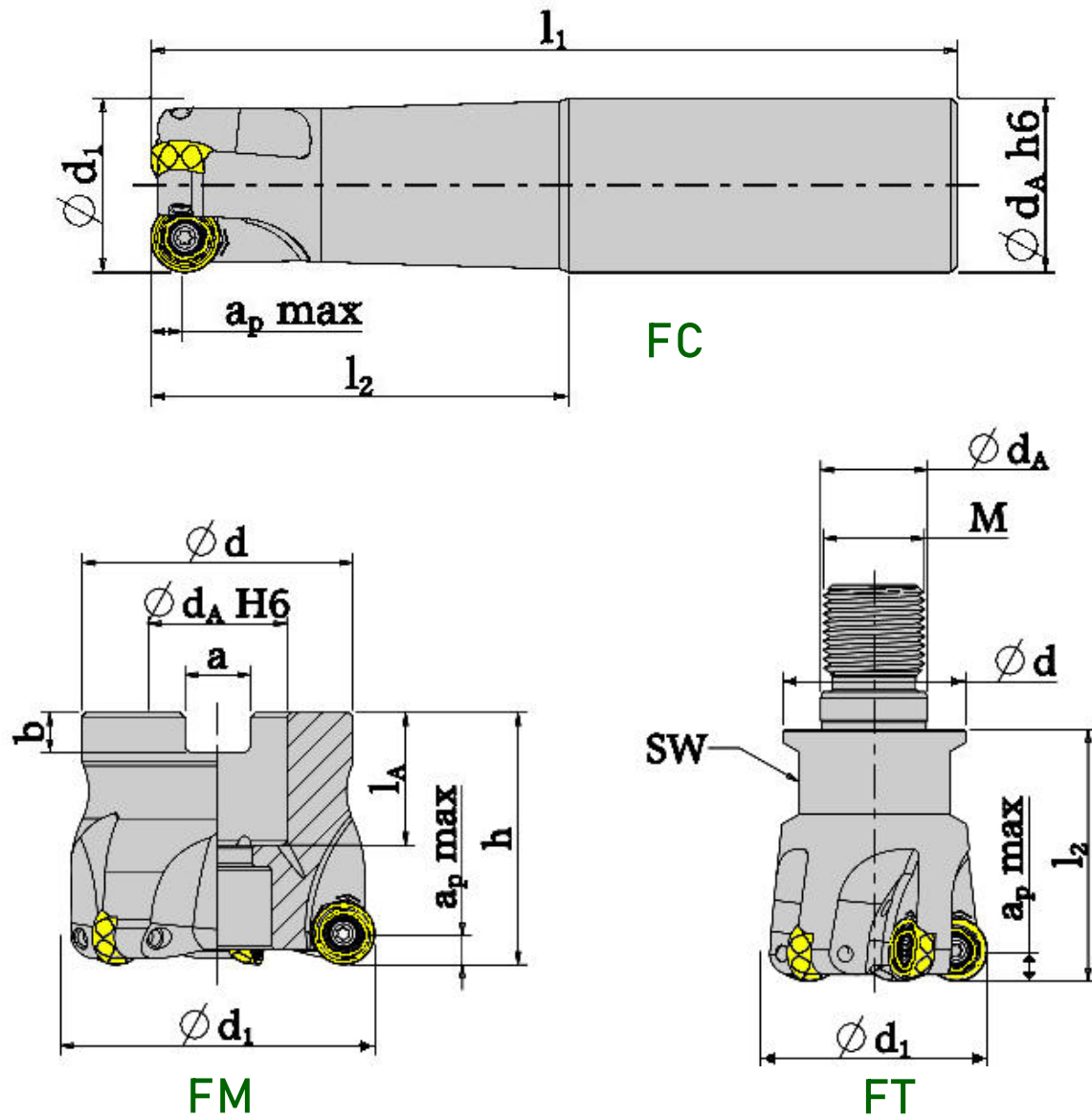



| Denominazione | Quantità | Per inserto | Ricambi |
|---------------|----------|-------------------|---|
| VBTL30/C7 | 10 | R _ 10 | |
| VBTL40/C11 | 10 | R _ 12 x frese FM |  |
| VBTL40/C8 | 10 | R _ 12 x frese FC | |
| VBTL45/C13 | 10 | R _ 16 | |
| VBTL -D80/C | 10 | R _ 10 + R _ 12 |  |
| VBTL -D100/C | 10 | R _ 16 | |



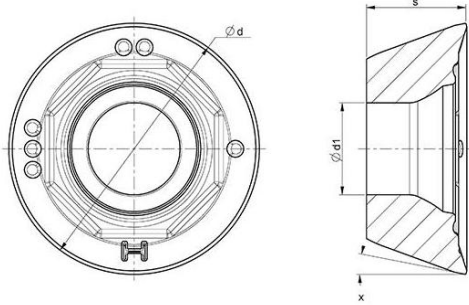

| Denominazione | l | s | d | l1 | d1 |
|----------------------|-------|------|----|-----|-----|
| RPHX 10T3MO -TX TC50 | | 3,97 | 10 | | 3,4 |
| RPHX 10T3MO -TX TC14 | | 3,97 | 10 | | 3,4 |
| RPHX 1204MO -TX TC50 | | 4,76 | 12 | | 4,4 |
| RPHX 1204MO -TX TC14 | | 4,76 | 12 | | 4,4 |
| RPHX 1605MO -TX TC50 | | 5,56 | 16 | | 5,5 |
| RPHX 1605MO -TX TC14 | | 5,56 | 16 | | 5,5 |
| RPMX 10T3MO -TM TC25 | | 3,97 | 10 | | 3,4 |
| RPMX 10T3MO -TM TC35 | | 3,97 | 10 | | 3,4 |
| RPMX 10T3MO -TS TC50 | | 3,97 | 10 | | 3,4 |
| RPMX 10T3MO -TS TM35 | | 3,97 | 10 | | 3,4 |
| RPMX 1204MO -TM TC25 | | 4,76 | 12 | | 4,4 |
| RPMX 1204MO -TM TC35 | | 4,76 | 12 | | 4,4 |
| RPMX 1204MO -SF TC25 | 11,75 | 4,76 | 12 | 2,4 | 4,4 |
| RPMX 1204MO -SF TC35 | 11,75 | 4,76 | 12 | 2,4 | 4,4 |
| RPMX 1204MO -TS TC50 | 11,75 | 4,76 | 12 | 2,4 | 4,4 |
| RPMX 1204MO -TS TM35 | 11,75 | 4,76 | 12 | 2,4 | 4,4 |
| RPMX 1204MO -TS TM35 | | 4,76 | 12 | | 4,4 |
| RPMX 1605MO -TM TC25 | | 5,56 | 16 | | 5,5 |
| RPMX 1605MO -TM TC35 | | 5,56 | 16 | | 5,5 |
| RPMX 1605MO -SF TC25 | 15,8 | 5,56 | 16 | 2,5 | 5,5 |
| RPMX 1605MO -SF TC35 | 15,8 | 5,56 | 16 | 2,5 | 5,5 |
| RPMX 1605MO -TS TC50 | 15,8 | 5,56 | 16 | 2,5 | 5,5 |
| RPMX 1605MO -TS TM35 | 15,8 | 5,56 | 16 | 2,5 | 4,4 |
| RPMX 1605MO -TS TC50 | | 5,56 | 16 | | 5,5 |
| RPMX 1605MO -TS TM35 | | 5,56 | 16 | | 5,5 |

| Denominazione | s | d | d1 | x |
|----------------------|------|----|-----|---------|
| RDHW 10T3MOSN TK15 | 3,97 | 10 | 3,4 | 15,00 ° |
| RDHW 1204MOSN TK15 | 4,76 | 12 | 4,4 | 15,00 ° |
| RDHX 10T3MO -AL A10M | 3,97 | 10 | 3,4 | 15,00 ° |
| RDHX 1204MO -AL A10M | 3,97 | 12 | 3,4 | 15,00 ° |

TM

Tagliante robusto per applicazioni generiche di fresatura acciaio in condizioni difficili

Strong cutting edge for general steel applications and hard conditions milling

TS

Tagliante affilato per applicazioni generiche su acciaio inossidabile e per la finitura degli acciai.

Sharp cutting edge for general stainless steel applications and for finishing in steels.

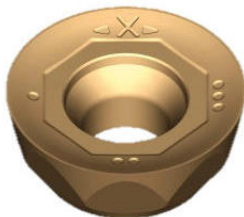
TX

Tagliante stabile dedicato a materiali esotici e titanio.

Stable cutting edge for dedicated exotic materials and titanium.

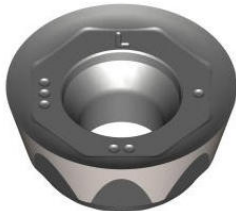
AL

Tagliante estremamente affilato per alluminio e metalli non ferrosi.

Extremely sharp cutting edge for aluminum and non-ferrous metals.

SN

Forte tagliante rinforzato per materiale duro.

Strong reinforced cutting edge for hard material.

SF

Forte tagliante rinforzato per applicazioni generiche.

Strong reinforced cutting edge for general applications.

1 UTENSILE FLESSIBILE PER DIVERSI INSERTI

ottimizzazione angolo di taglio per diverse operazioni

FLEXIBILITY - 1 TOOL FOR SEVERAL INSERTS

optimised clearance angle for high performance

11° (RP...): for Steel. Stainless steel. Cast iron and exotic materials
 15° (RD...): for Hard materials and non-ferrous metals.

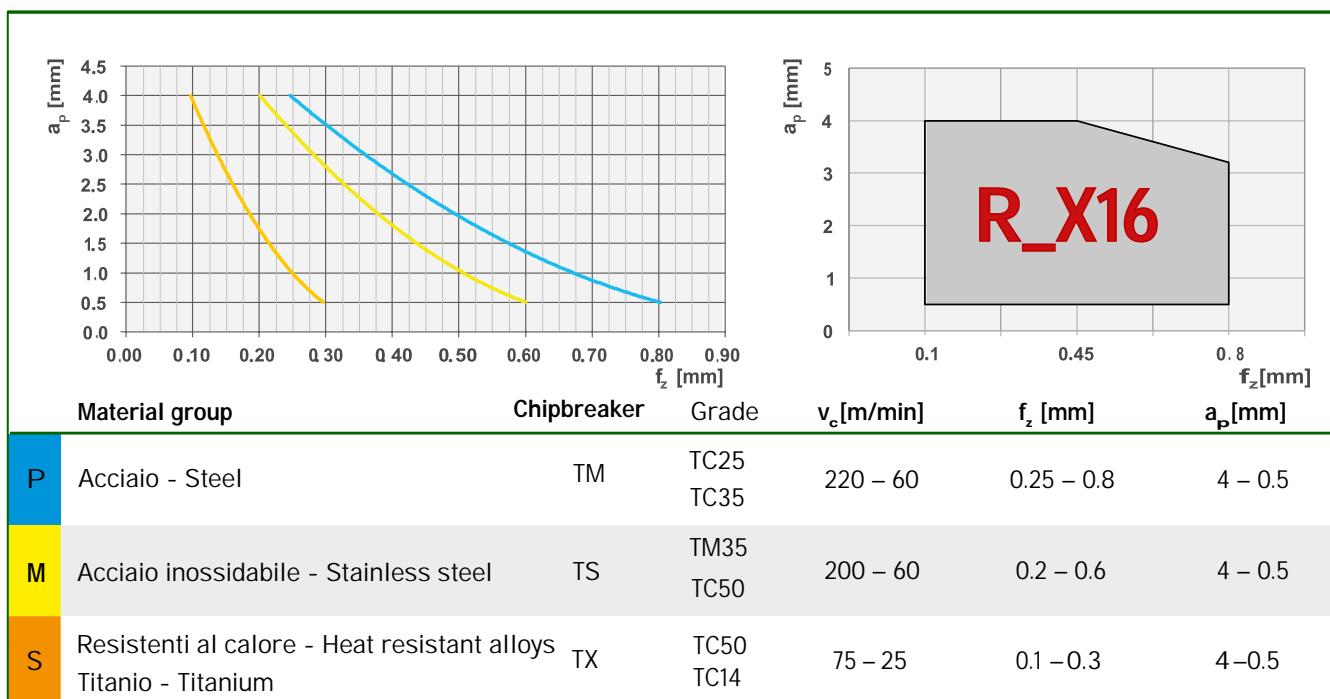

PARAMETRI DI TAGLIO - CUTTING DATA

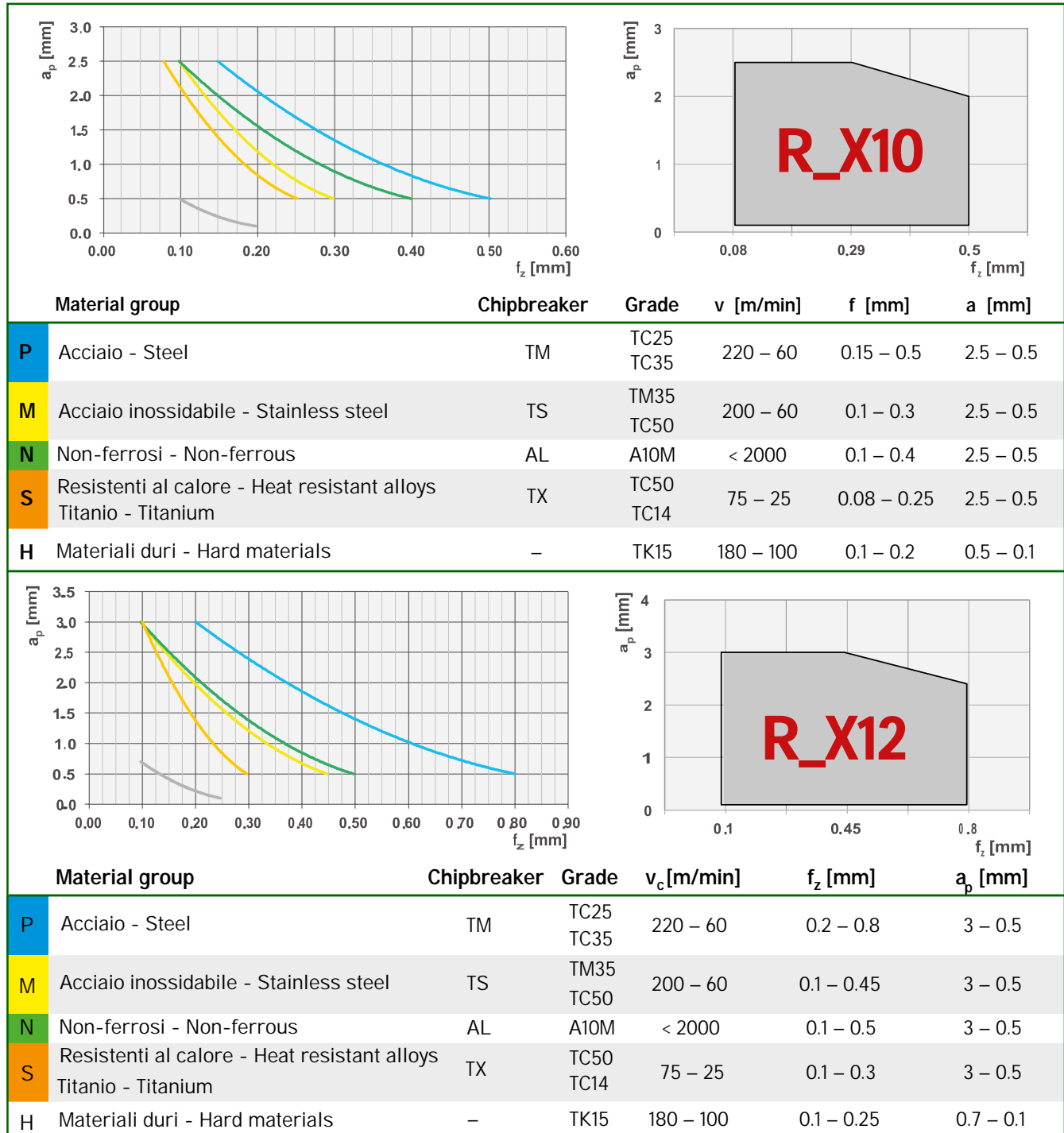

| | 4 times | | 8 times |
|--------------|---------------------|------------------------|------------------------|
| ∅ [mm] | a _p [mm] | a _{pmax} [mm] | a _{pmax} [mm] |
| 10 | 2.5 | 4.5 | 1.4 |
| 12 | 3.0 | 5.5 | 1.7 |
| 16 | 4.0 | 7.5 | 2.3 |
| Recommended! | | | |

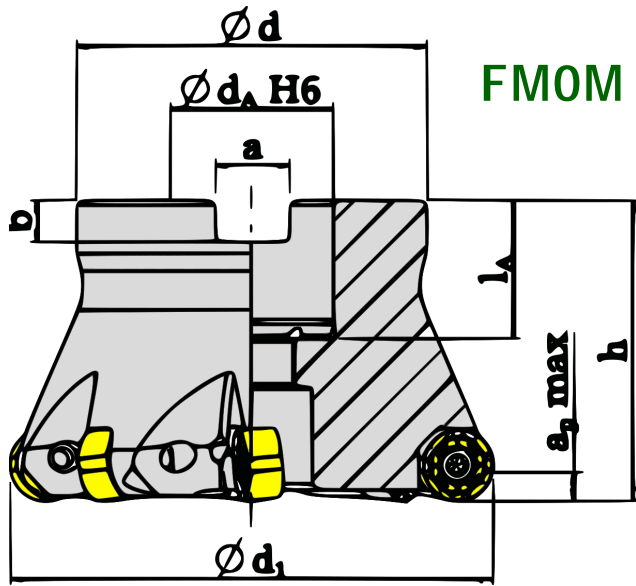

| Denominazione | d1 | l1 | l2 | h | dA | ap max | nmax | z |
|-----------------------------|-----|-----|----|----|----|--------|-------|----|
| FMOM - R12-100.R.10 | 100 | | | 50 | 32 | 4,5 | 6350 | 10 |
| FMOM - R12-40.R.04 | 40 | | | 40 | 16 | 4,5 | 15900 | 4 |
| FMOM - R12-50.R.05 | 50 | | | 40 | 22 | 4,5 | 12700 | 5 |
| FMOM - R12-63.R.06 | 63 | | | 40 | 22 | 4,5 | 10100 | 6 |
| FMOM - R12-80.R.08 | 80 | | | 50 | 27 | 4,5 | 7950 | 8 |
| FCOM - R12-32.R.03-A-70 | 32 | 131 | 70 | | 32 | 4,5 | 19000 | 3 |
| FCOM - R12-32.R.03-A-70-165 | 32 | 165 | 70 | | 32 | 4,5 | 17000 | 3 |

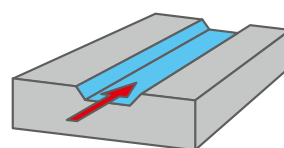
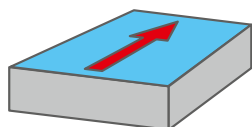
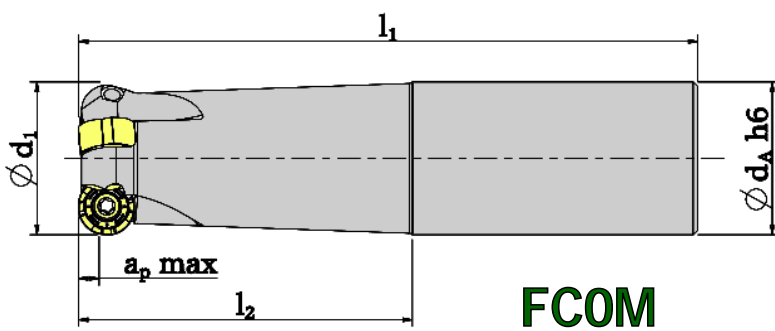

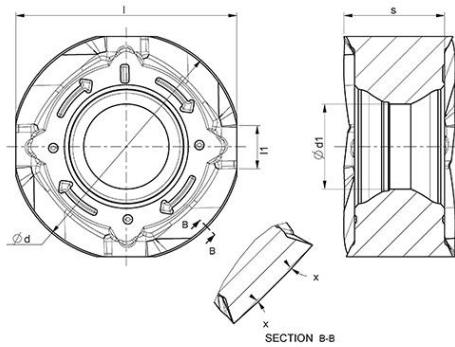

| Denominazione | l | s | d | l1 | d1 |
|------------------------|------|-----|----|-----|-----|
| ROHU 1204MOER -TS TC50 | 11,8 | 5,9 | 12 | 2,3 | 4,5 |
| ROHU 1204MOER -TS TM35 | 11,8 | 5,9 | 12 | 2,3 | 4,5 |
| ROHU 1605MOER _TS TC50 | 15,7 | 6,7 | 16 | 2,7 | 5,8 |
| ROHU 1605MOER -TS TM35 | 15,7 | 6,7 | 16 | 2,7 | 5,8 |

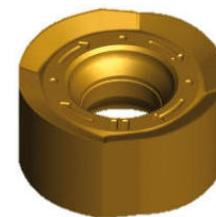
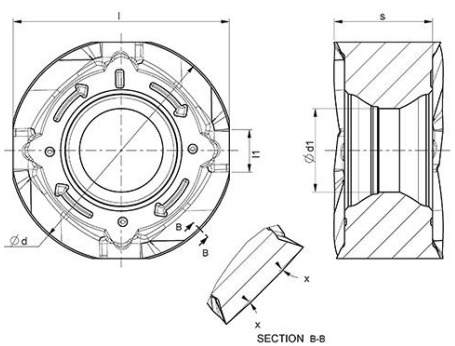

| Denominazione | l | s | d | l1 | d1 | x |
|------------------------|------|-----|----|-----|-----|-----|
| RNKU 1204MOER -TM TC25 | 11,8 | 5,9 | 12 | 2,3 | 4,5 | 0 ° |
| RNKU 1204MOER -TM TC35 | 11,8 | 5,9 | 12 | 2,3 | 4,5 | 0 ° |
| RNKU 1605MOER _TM TC25 | 15,7 | 6,7 | 16 | 2,7 | 5,8 | 0 ° |
| RNKU 1605MOER -TM TC35 | 15,7 | 6,7 | 16 | 2,7 | 5,8 | 0 ° |

| Denominazione | Quantità | Per inserto | Ri cambi |
|---------------|----------|------------------|----------|
| VBTL40/C11 | 10 | R_ 12 x frese FM | |
| VBTL40/C8 | 10 | R_ 12 x frese FC | |
| VBTL45/C13 | 10 | R_ 16 | |
| VBTL-D80/C | 10 | FM0M-R12-40.R.04 | |

4 taglienti reversibili 8 totali
Indexing 4 times and reversible

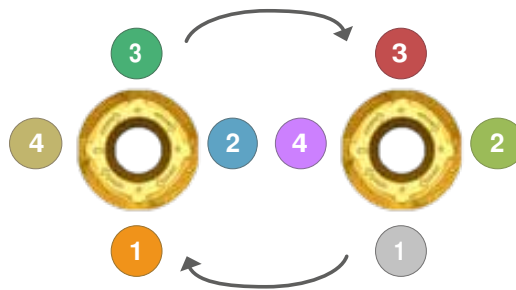

PARAMETRI DI TAGLIO - CUTTING DATA

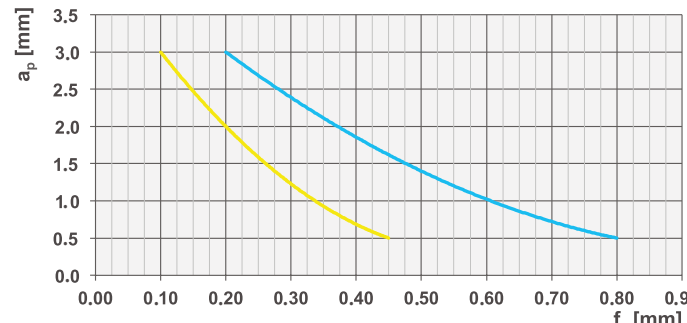
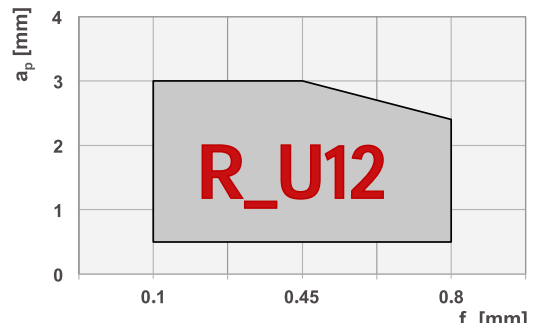
|  | | |  | | |
|--|-------------|--------------|---|------------|------------|
| Material group | Chipbreaker | Grade | v_c [m/min] | f_z [mm] | a_p [mm] |
| P Acciaio - Steel | TM | TC25 TC35 | 220 – 60 | 0.2 – 0.8 | 3 – 0.5 |
| M Acciaio inossidabile - Stainless steel | TS | TM35 TC50 | 200 – 60 | 0.1 – 0.45 | 3 – 0.5 |

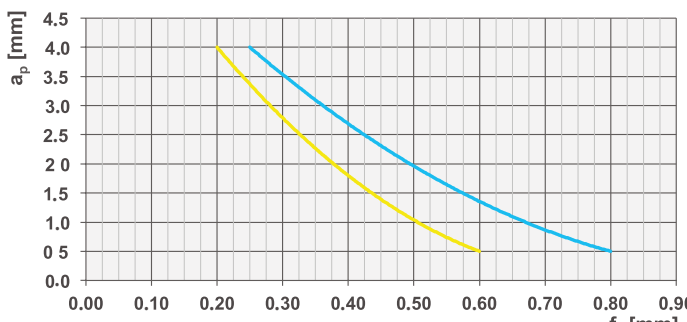
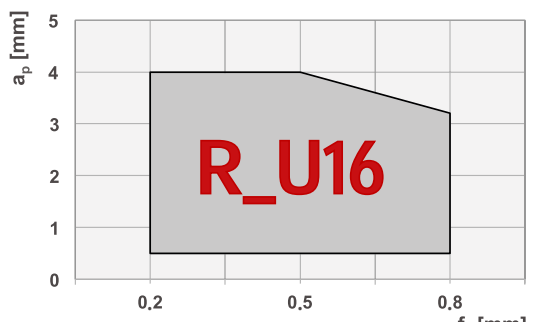
|  | | |  | | |
|---|-------------|--------------|--|------------|------------|
| Material group | Chipbreaker | Grade | v_c [m/min] | f_z [mm] | a_p [mm] |
| P Acciaio - Steel | TM | TC25 TC35 | 220 – 60 | 0.25 – 0.8 | 4 – 0.5 |
| M Acciaio inossidabile - Stainless steel | TS | TM35 TC50 | 200 – 60 | 0.2 – 0.6 | 4 – 0.5 |

HIGH FEED CUTTING F_X

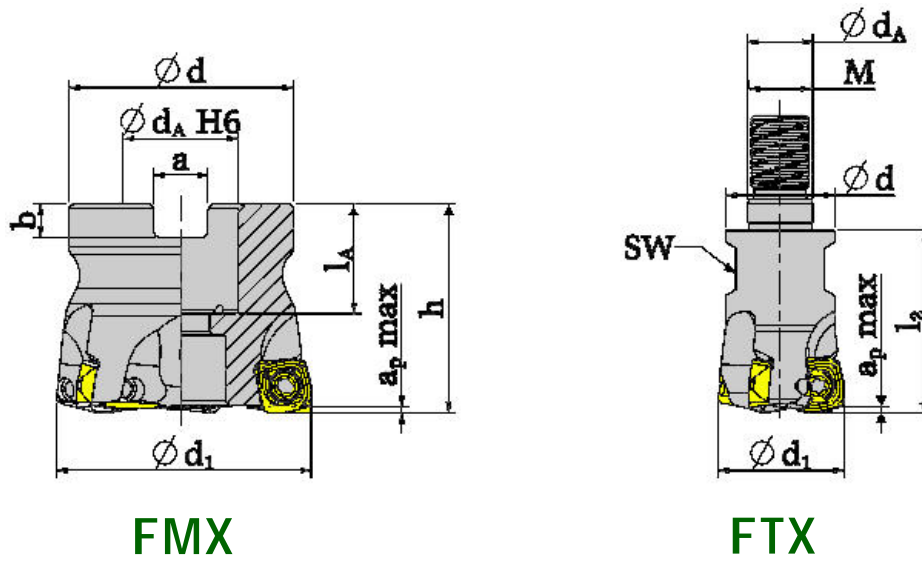

FMX

FTX

| Denominazione | d1 | l1 | l2 | h | dA | ap max | nmax | z |
|--------------------------|----|-----|----|----|----|--------|-------|---|
| FMX-S10-40.R.04 | 40 | | | 40 | 16 | 1 | 26400 | 4 |
| FMX-S10-50.R.05 | 50 | | | 40 | 22 | 1 | 23500 | 5 |
| FMX-S10-63.R.06 | 63 | | | 40 | 22 | 1 | 20500 | 6 |
| FMX-S13-50.R.04 | 50 | | | 40 | 22 | 2 | 18800 | 4 |
| FMX-S13-63.R.05 | 63 | | | 40 | 22 | 2 | 16400 | 5 |
| FMX-S13-80.R.07 | 80 | | | 50 | 27 | 2 | 14000 | 7 |
| FCX-S07-16.R.02-A-50-200 | 16 | 200 | 50 | | 16 | 0,8 | 4600 | 2 |
| FCX-S07-20.R.03-A-50-200 | 20 | 200 | 50 | | 20 | 0,8 | 4200 | 3 |
| FCX-S07-25.R.04-A-50-200 | 25 | 200 | 50 | | 25 | 0,8 | 3900 | 4 |
| FCX-S10-25.R.03-A-50-225 | 25 | 225 | 50 | | 25 | 1 | 9000 | 3 |
| FCX-S13-35.R.03-A-63-250 | 35 | 250 | 63 | | 32 | 2 | 6400 | 3 |
| FTX-S07-16.R.02 | 16 | | | | 16 | 0,8 | 20800 | 2 |
| FTX-S07-20.R.03 | 20 | | | | 20 | 0,8 | 19800 | 3 |
| FTX-S07-25.R.04 | 25 | | | | 25 | 0,8 | 18700 | 4 |

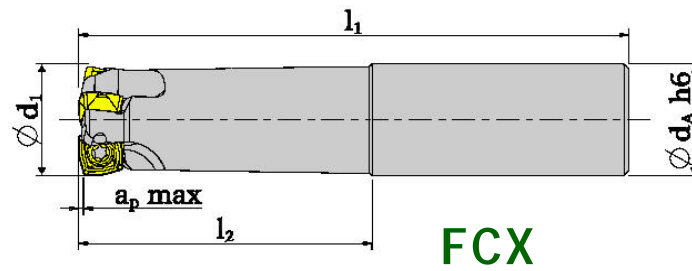

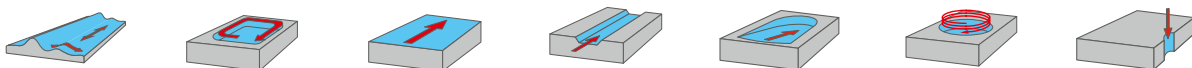

FCX



HIGH FEED CUTTING F_X



| Denominazione | Quantità | Per inserto | Ri cambi |
|---------------|----------|-----------------|---|
| VBTL25/C5 | 10 | S07 | |
| VBTL35/C7 | 10 | S10 - FCX |  |
| VBTL35/C8 | 10 | S10 - FMX | |
| VBTL45/C10 | 10 | S13 | |
| VBTL-D80/C | 10 | FMX-S10-40.R.04 |  |

HIGH FEED CUTTING INSERTS

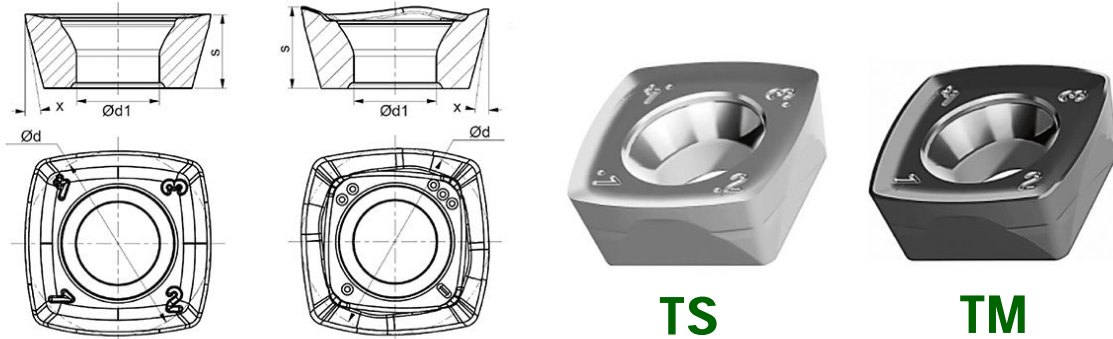

| Denominazione | s | d | r | d1 |
|-----------------------|------|----|---|-----|
| SDNX 130410ER-TS TC50 | 4,76 | 13 | 1 | 5,5 |
| SDNX 130410ER-TS TM35 | 4,76 | 13 | 1 | 5,5 |
| SDNX 130410SR-TM TC25 | 4,76 | 13 | 1 | 5,5 |
| SDNX 130410SR-TM TK15 | 4,76 | 13 | 1 | 5,5 |
| SDNX 130410SR-TM TC35 | 4,76 | 13 | 1 | 5,5 |

PARAMETRI DI TAGLIO - CUTTING DATA

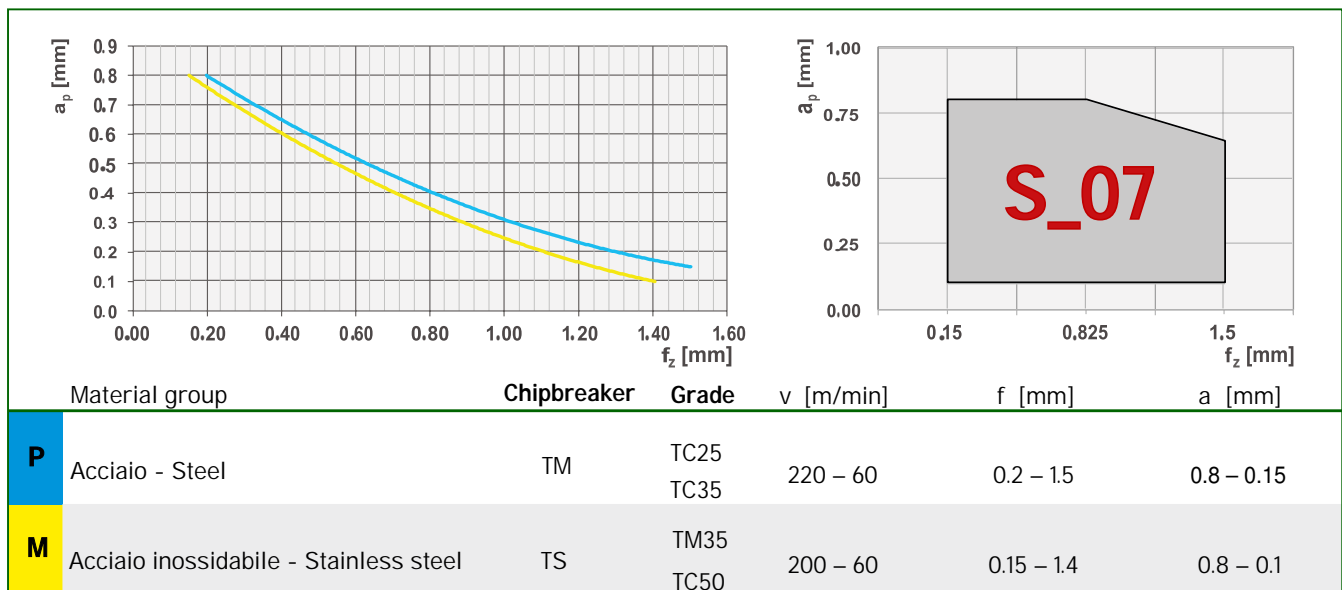

HIGH FEED CUTTING INSERTS

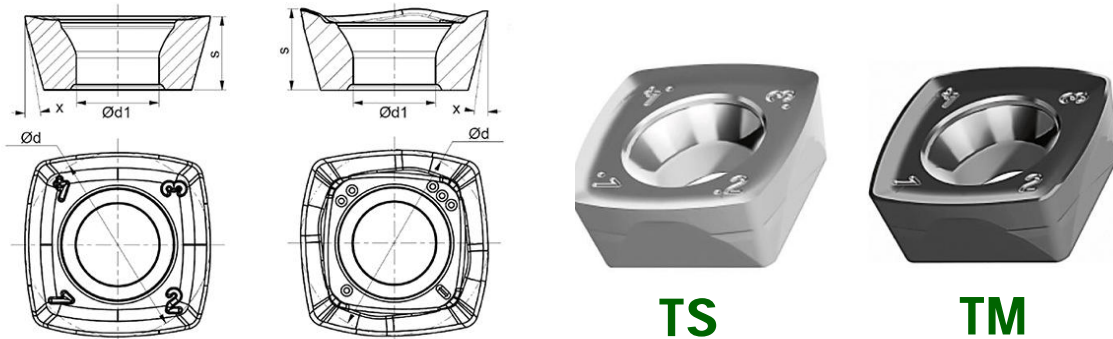

| Denominazione | s | d | r | d1 |
|-----------------------|------|---|-----|-----|
| SDNT 070305ER-TS TC50 | 2,75 | 7 | 0,5 | 2,8 |
| SDNT 070305ER-TS TM35 | 2,75 | 7 | 0,5 | 2,8 |
| SDNT 070305SR-TM TC25 | 2,75 | 7 | 0,5 | 2,8 |
| SDNT 070305SR-TM TC35 | 2,75 | 7 | 0,5 | 2,8 |

PARAMETRI DI TAGLIO - CUTTING DATA

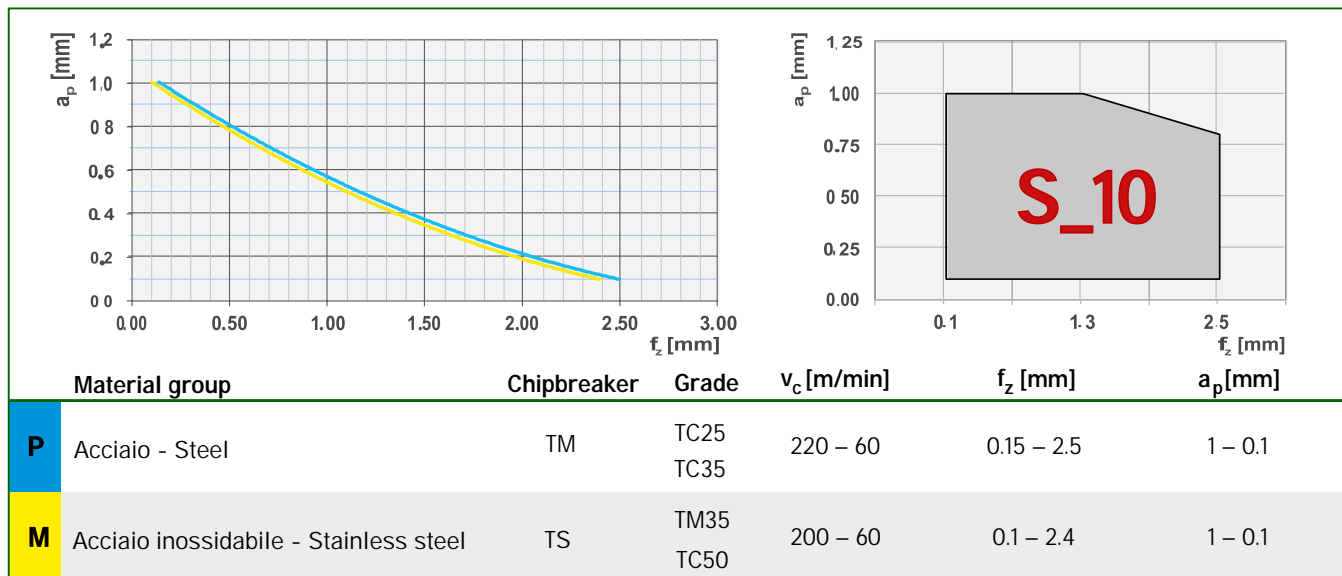

HIGH FEED CUTTING INSERTS

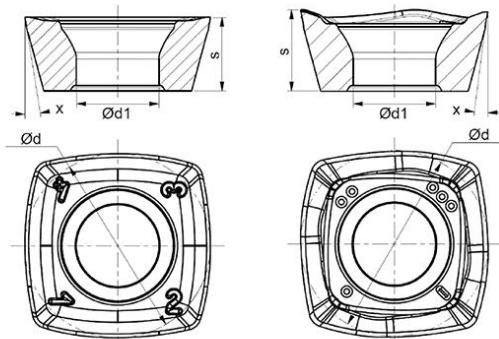

TS

TM

| Denominazione | s | d | r | d1 | x |
|-----------------------|------|----|-----|-----|---------|
| SDKT 10T308ER-TS TC50 | 3,97 | 10 | 0,8 | 4,4 | 15,00 ° |
| SDKT 10T308ER-TS TM35 | 3,97 | 10 | 0,8 | 4,4 | 15,00 ° |
| SDKT 10T308SR-TM TC25 | 3,97 | 10 | 0,8 | 4,4 | 15,00 ° |
| SDKT 10T308SR-TM TC35 | 3,97 | 10 | 0,8 | 4,4 | 15,00 ° |
| SDKX 10T308SR-TM TC25 | 4,38 | 10 | 0,8 | 4,4 | 15,00 ° |
| SDKX 10T308SR-TM TC35 | 4,38 | 10 | 0,8 | 4,4 | 15,00 ° |
| SDKX 10T308SR-TS TC50 | 4,38 | 10 | 0,8 | 4,4 | 15,00 ° |
| SDKX 10T308SR-TS TM35 | 4,38 | 10 | 0,8 | 4,4 | 15,00 ° |

PARAMETRI DI TAGLIO - CUTTING DATA

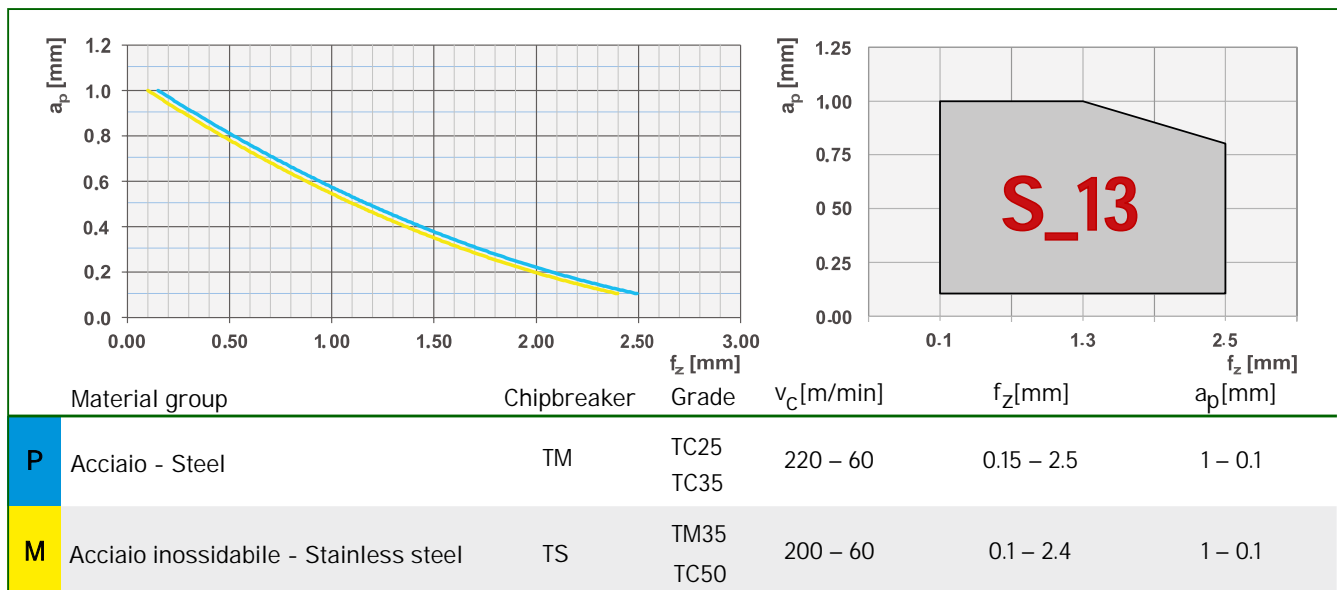

TUNGSTEN
CARBIDE
TOOLS

EFFECTIVE CUTTING EDGE

4 taglienti effettivi
4 effective cutting edges



disponibile in 3 dimensioni
Available in 3 dimensions



CI 07 CI 10 CI 13

TM



Tagliente robusto per applicazioni generiche di fresatura acciaio in condizioni difficili

Strong cutting edge for general steel applications and hard conditions milling

TS



Tagliente affilato per applicazioni generiche su acciaio inossidabile e per la finitura degli acciai.

Sharp cutting edge for general stainless steel applications and for finishing in steels.

SDKX 10T308SR-TM



SDNT 070305ER-TM



SDNT 070305ER-TS

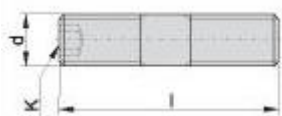

SPARE PARTS - SCREW**VITE DIFFERENZIALE - POWER SCREW**

| Denominazione | Quantità | d | l | K |
|---------------|----------|-----|----|-----|
| VBTL-D80/C | 10 | M8 | 30 | SW4 |
| VBTL-D100/C | 10 | M10 | 31 | SW5 |

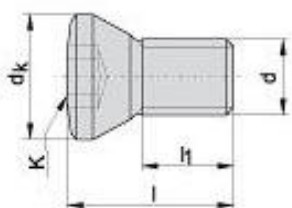
**VITE TORX - TORX SCREW**

| Denominazione | Quantità | d | l | l1 | dk | K |
|---------------|----------|------|------|-----|-----|------|
| VBTL-S40 | 10 | | | | | T15 |
| VBTL30/C7 | 10 | M3 | 7,5 | 4,4 | 4,2 | 10IP |
| VBTL35/C7 | 10 | M3,5 | 7,2 | 3,8 | 5,2 | T15 |
| VBTL25/C6 | 10 | M2,5 | 6 | 3,6 | 3,5 | T08 |
| VBTL40/C8 | 10 | M4 | 8,5 | 5,5 | 5,5 | T15 |
| VBTL40/C11 | 10 | M4 | 11 | 8 | 5,5 | T15 |
| VBTL45/C10 | 10 | M4,5 | 10,5 | 6,3 | 6,6 | T20 |
| VBTL30/C7 | 10 | M3 | 7,3 | 4,7 | 4,1 | T08 |
| VBTL25/C5 | 10 | M2,5 | 5 | 2,6 | 3,5 | T08 |
| VBTL35/C8 | 10 | M3,5 | 8,6 | 5,6 | 5,2 | T15 |
| VBTL45/C13 | 10 | M4,5 | 13 | 8,8 | 6,6 | T20 |

STANDARD INSERTS

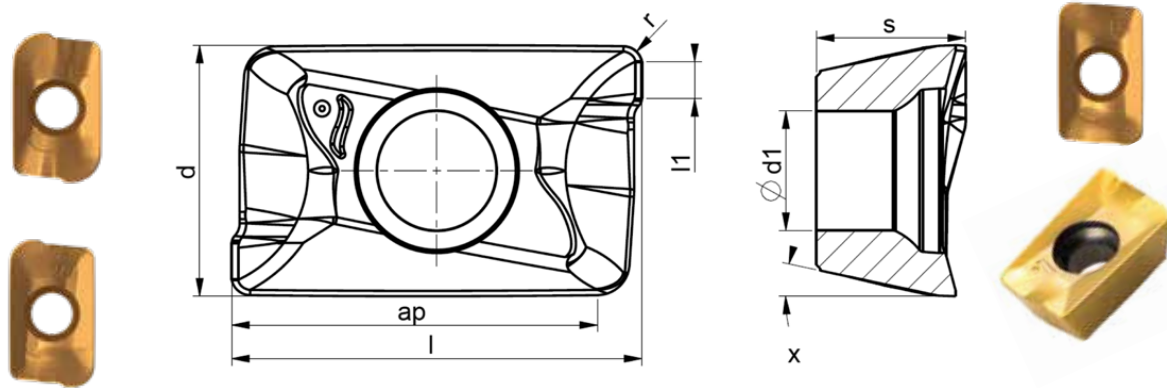

| Desscrizione | l [mm] | s [mm] | d [mm] | ap [mm] | l1 [mm] | r [mm] | d1 [mm] | x [°] |
|------------------|--------|--------|--------|---------|---------|--------|---------|-------|
| ADKT 1505PDER-TM | 15.5 | 5.65 | 9.45 | 13.8 | 1.4 | 0.75 | 4.5 | 12 |
| ADKT 1505PDER-TS | 15.5 | 5.95 | 9.45 | 13.8 | 1.5 | 0.75 | 4.5 | 12 |
| ADKT 150516-TM | 15.6 | 6.1 | 9.45 | 13.8 | 0.6 | 1.6 | 4.5 | 12 |
| ADKT 150524-TM | 16.2 | 6.1 | 9.45 | 14.1 | 0.7 | 2.4 | 4.5 | 12 |
| ADKT 150532-TM | 16.3 | 6.1 | 9.45 | 14.2 | 0.4 | 3.2 | 4.5 | 12 |

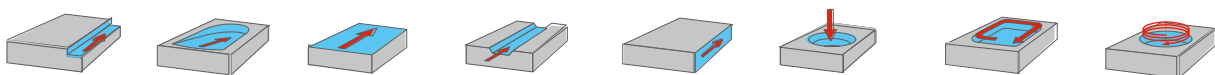
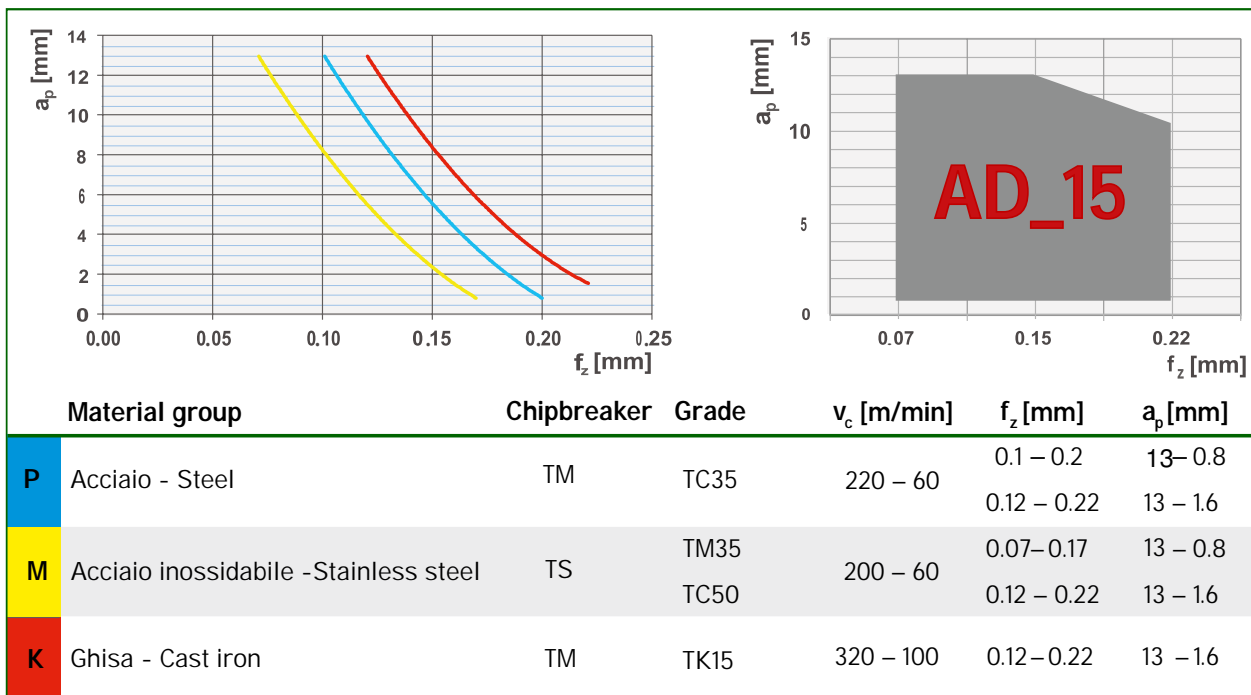

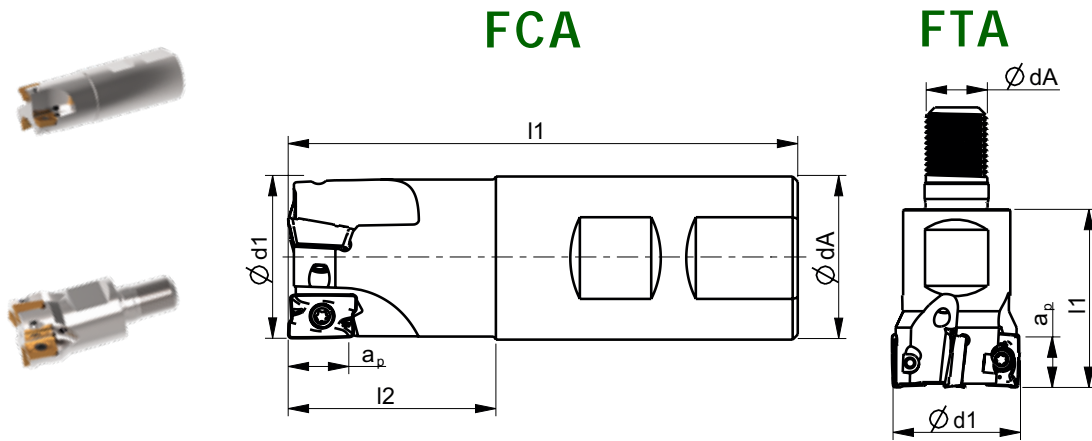

| Descrizione | d1 [mm] | l1 [mm] | l2 [mm] | dA [mm] | ap [mm] | n_{max} [min ⁻¹] | Z |
|-----------------------|---------|---------|---------|---------|---------|--------------------------------|---|
| FCA-AP10-16.R.02-B-35 | 16 | 85 | 35 | 16 | | 28.000 | 2 |
| FCA-AP10-20.R.03-B-38 | 20 | 90 | 38 | 20 | | 25.000 | 3 |
| FCA-AP10-25.R.04-B-42 | 25 | 100 | 42 | 25 | | 22.000 | 4 |
| FCA-AP10-32.R.05-B-48 | 32 | 110 | 48 | 32 | 10 | 20.000 | 5 |
| FTA-AP10-20.R.03 | 20 | 30 | - | M10 | | 25.000 | 2 |
| FTA-AP10-25.R.04 | 25 | 35 | - | M12 | | 22.000 | 3 |
| FTA-AP10-32.R.05 | 32 | 42 | - | M16 | | 20.000 | 4 |

| Ricambi | Designation | Disponibilità |
|---------|-------------|---------------|
|---------|-------------|---------------|



M2.5X5.6 – T08

•

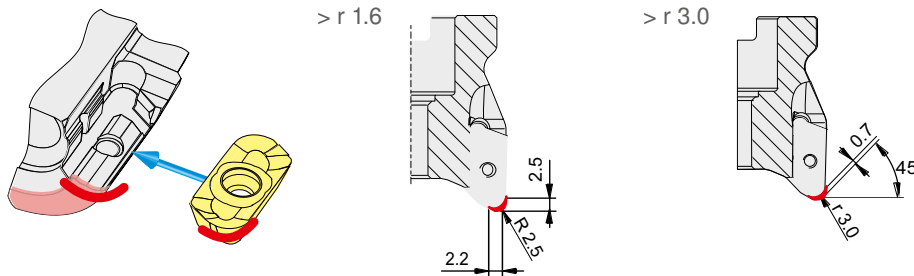

INSERTI STANDARD - AP_T 10

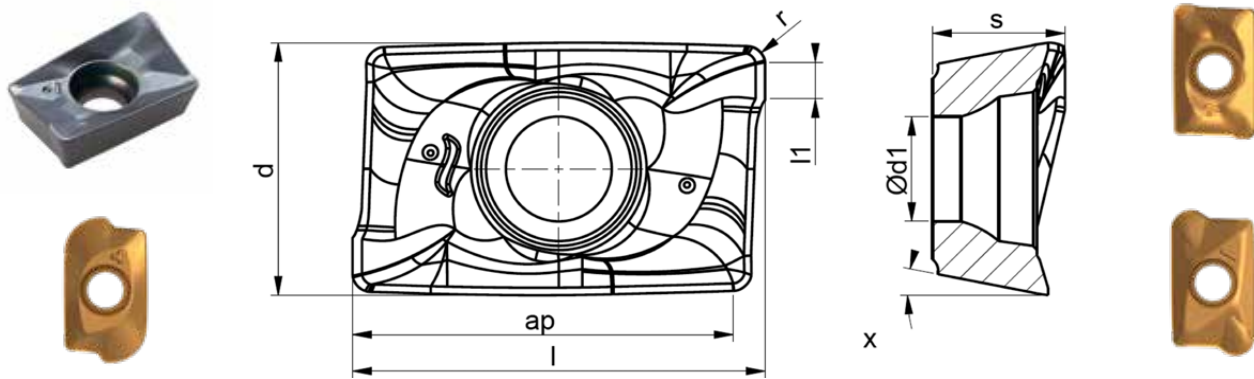

| Descrizione | l [mm] | s [mm] | d [mm] | ap [mm] | l1 [mm] | r [mm] | d1 [mm] | x [°] |
|-------------------|--------|--------|--------|---------|---------|--------|---------|-------|
| APKT 1003PDER-HCM | 10.9 | 3.5 | 6.74 | 10 | 1 | 0.5 | 2.8 | 11 |
| APKT 1003PDER-SCM | 10.9 | 3.5 | 6.74 | 10 | 1 | 0.5 | 2.8 | 11 |
| APHT 1003PDER-LMM | 10.6 | 3 | 6.74 | 10 | 2.2 | 0.85 | 2.85 | 11 |
| APKT 100308-RCM | 10.9 | 3.5 | 6.71 | 10 | 0.64 | 0.85 | 2.8 | 11 |
| APKT 100316-RCM | 11.7 | 3.4 | 6.66 | 10.4 | 0 | 1.6 | 2.85 | 11 |
| APKT 100330-RCM | 11.7 | 3.4 | 6.66 | 10.1 | 0.2 | 3 | 2.85 | 11 |

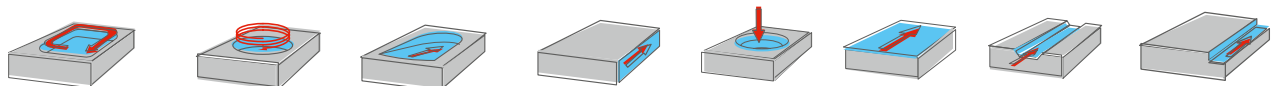
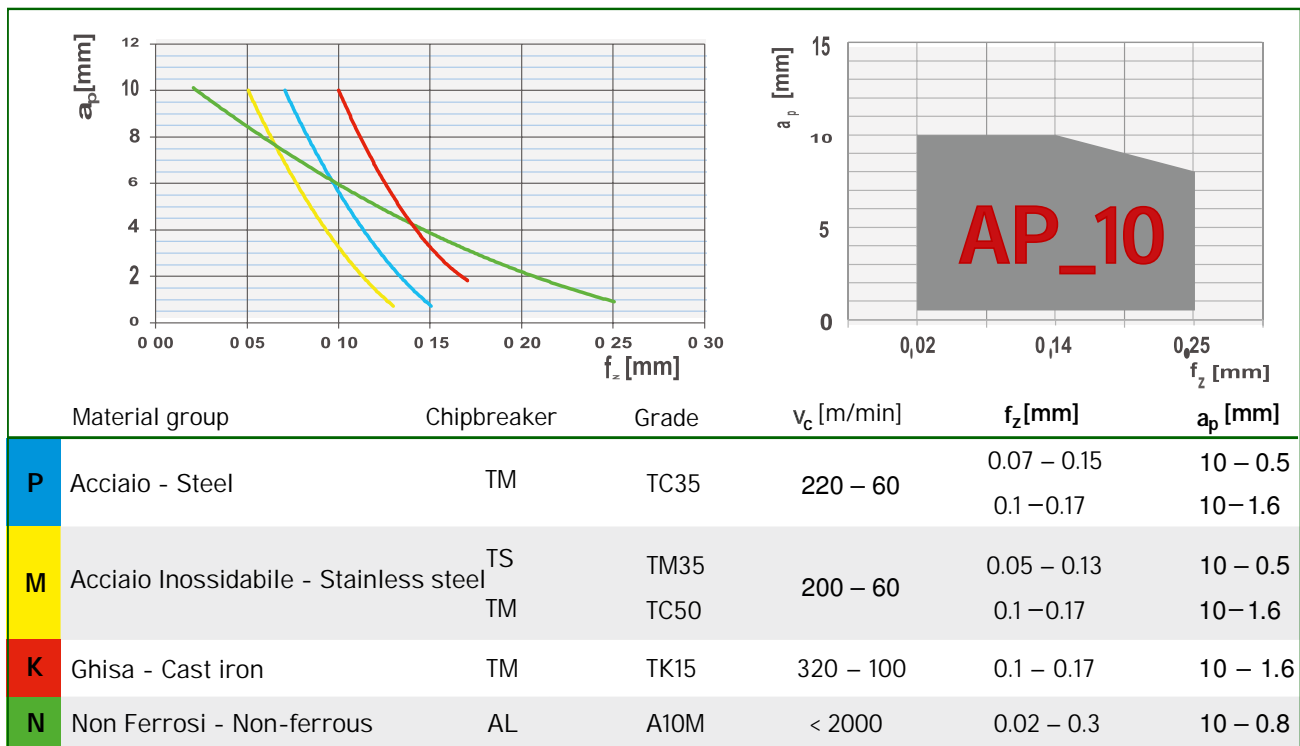

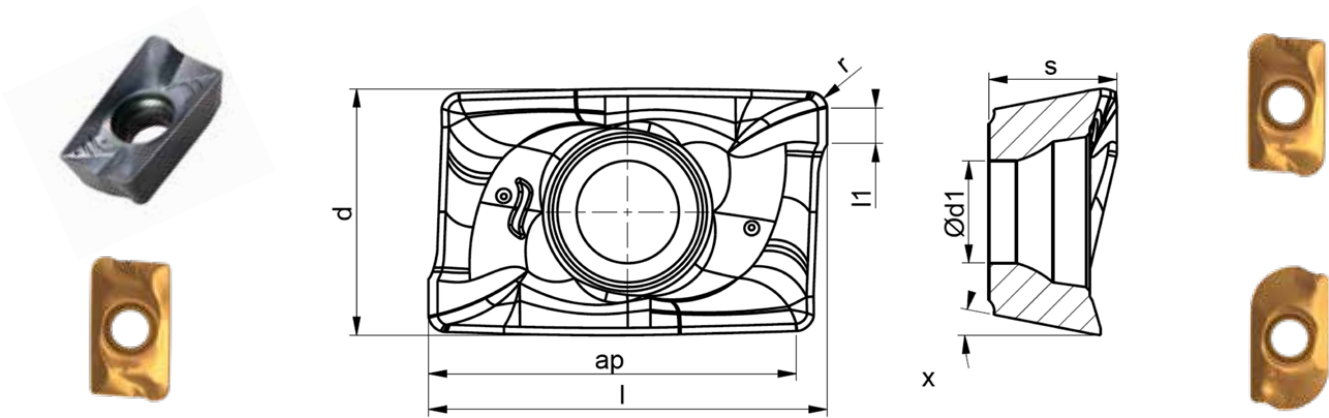

| Descrizione | l [mm] | s [mm] | d [mm] | ap [mm] | l1 [mm] | r [mm] | d1 [mm] | x [°] |
|-------------------|--------|--------|--------|---------|---------|--------|---------|-------|
| APKT 1604PDER-HCM | 17.15 | 5.25 | 9.5 | 15.3 | 1.4 | 0.85 | 4.4 | 11.5 |
| APKT 1604PDER-SCM | 17.1 | 5.25 | 9.5 | 15.3 | 1.4 | 0.85 | 4.4 | 11.5 |
| APHT 1604PDFR-LMM | 16.65 | 4.65 | 9.65 | 15.45 | 2 | 0.95 | 4.4 | 11.5 |
| APKT 160416-RCM | 17.15 | 5.25 | 9.5 | 15.3 | 0.65 | 1.6 | 4.4 | 11.5 |
| APKT 160424-RCM | 17.15 | 5.25 | 9.5 | 15.3 | 0.6 | 2.4 | 4.4 | 11.5 |
| APKT 160432-RCM | 17.1 | 5.25 | 9.5 | 15.3 | 0.3 | 3.2 | 4.4 | 11.5 |
| APKT 160448-RCM | 17.7 | 5.8 | 9.7 | 16 | 0.3 | 4.8 | 4.5 | 11.5 |

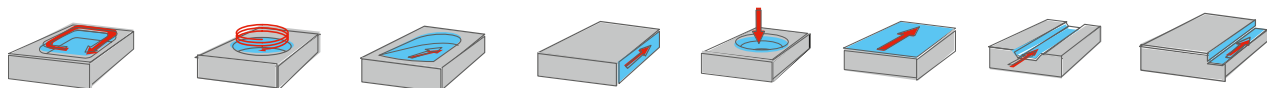
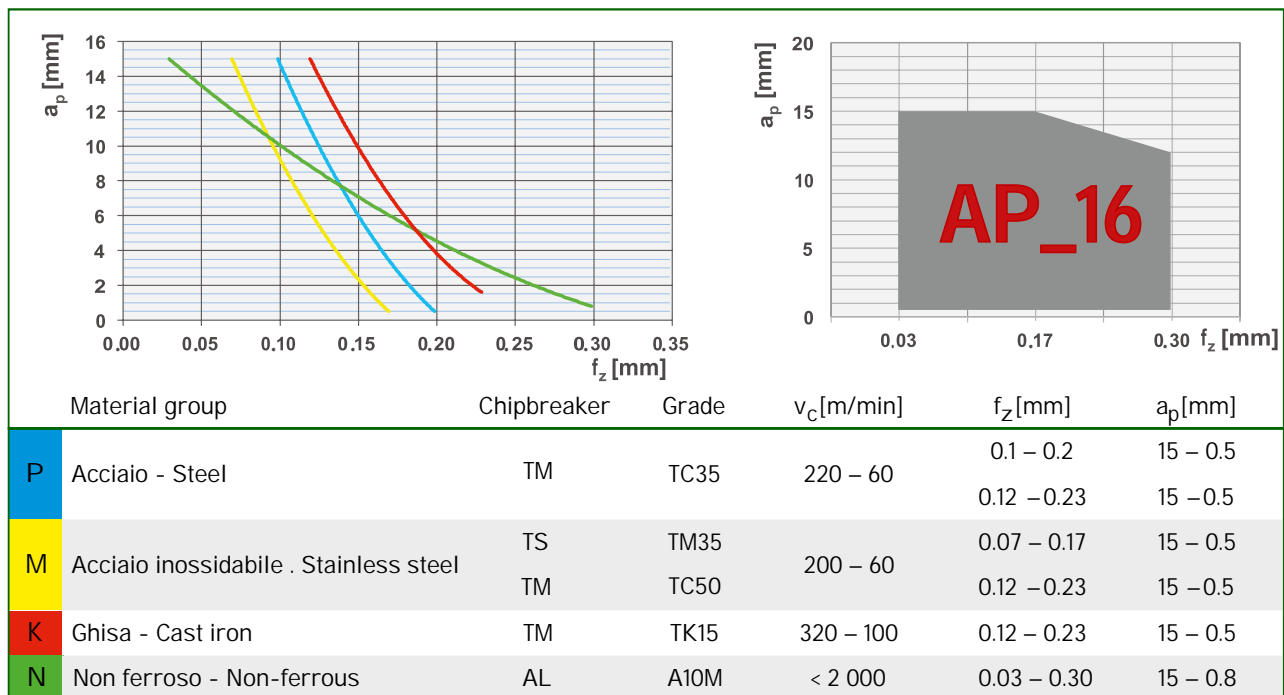

CATALOGO FRESATURA MILLING CATALOG

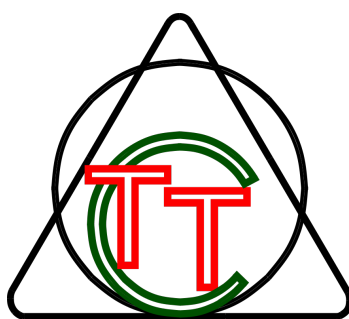

TUNGSTEN CARBIDE TOOLS

Via G. Boccaccio, 19
20025 Legnano (MI)
ITALIA

+39 (0)331/592303
info@tct-srl.it

ver. 01/2022